

INSTALLATION INSTRUCTIONS

LND(55,75)LKR-1 LINER KIT

LEAVE INSTRUCTIONS WITH THE HOMEOWNER.

BLACK REFLECTIVE GLASS LINER KIT	
Model	Description
DVLX(B,G)55BP90N-1	Single Sided, Black Reflective Glass
DVLXG75BP90N-1	Single Sided, Black Reflective Glass

CARTON CONTENTS			
Part Number	Description	Quantity Supplied	
R12954	Liner, Glass Reflective	9 - LND55LKR	13 - LND75LKR

TOOLS NEEDED: Phillips Screwdriver

INSTALL LINER

Installation Of Glass Liner

1. Remove barrier screen/glass and glass assemblies.
(See the owner's manual for instructions.)

2. Remove the (4) screws from the infill on a DVLX(B,G)55 fireplace. Remove (8) screws from the infill on a DVLXG75 fireplace. Lift the infill up, then pull it out from the firebox. Be careful not to scratch the side panels (shown in Figures 1a and 1b).

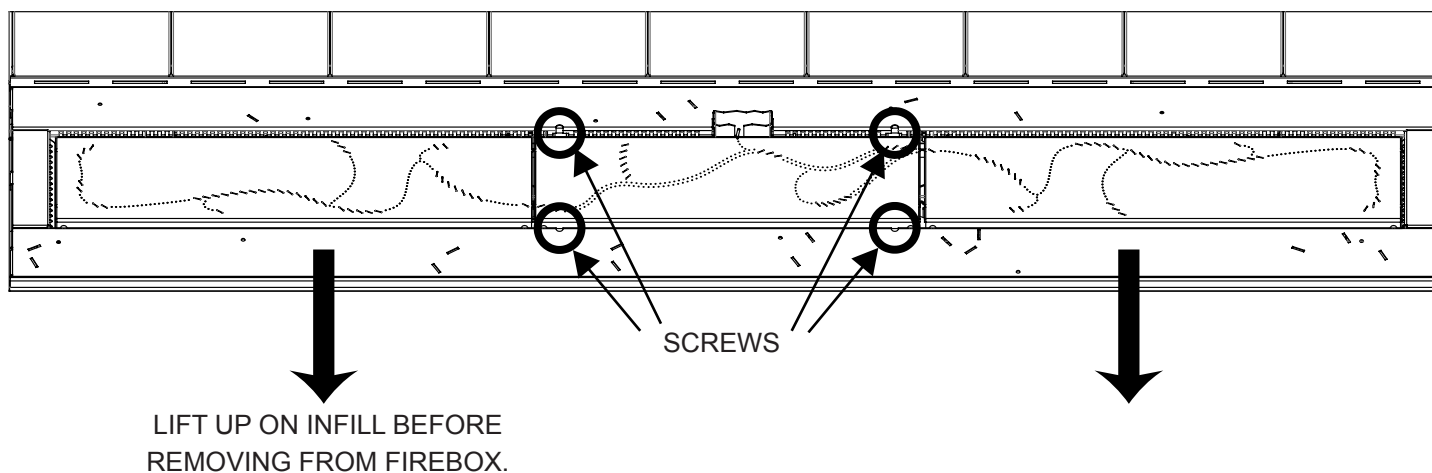

DVLX(B,G)55 - Figure 1a

NOTICE: Video of liner installation available on our website at: www.empirecomfort.com.

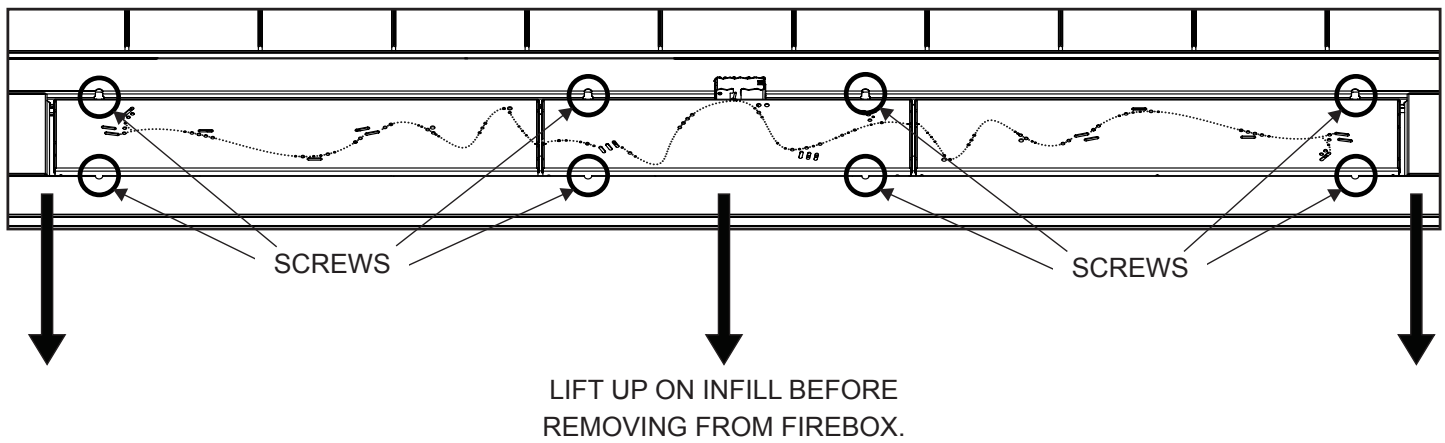

DVLXG75 - Figure 1b

Installation of Glass Liner

3. **DVLX(B,G)55** - Remove (2) screws from the top piece holding the liners. Back the third screw just enough for the liners to be loose. Remove the (9) liners. Going from left to right, slide the **BLACK REFLECTIVE LINERS** into place. (See Figures 2 and 3.)
4. **DVLXG75** - Remove (4) screws from the top piece holding the liners. Back the fifth screw just enough for the liners to be loose. Remove the (13) liners. Going from left to right, slide the **BLACK REFLECTIVE LINERS** into place.

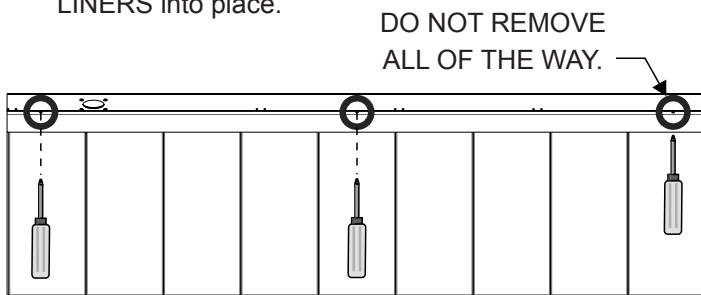

Figure 2

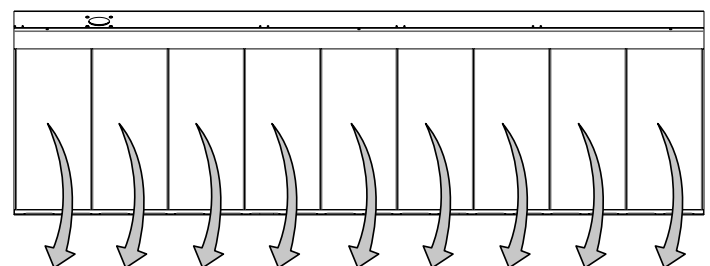

Figure 3

5. Reinstall the top piece to secure the liners to the firebox. Reinstall the infill, then the **GLASS DOOR** and **SCREEN FRAME** glass assemblies. **Liner kit installation is complete.**



SINCE 1932

www.empirecomfort.com

Empire Comfort Systems Inc.
Belleville, IL

If you have a general question
about our products, please e-mail
us at info@empirecomfort.com.

If you have a service or repair
question, please contact your dealer.