

INSTALLATION INSTRUCTIONS

(SEE HOMEOWNER MANUAL FOR OPERATING INSTRUCTIONS)

INSTALLER:

Leave this manual with the appliance.

CONSUMER:

Retain this manual for future reference.

⚠ WARNING

FIRE OR EXPLOSION HAZARD

Failure to follow safety warnings exactly could result in serious injury, death, or property damage.

- Do not store or use gasoline or other flammable vapors and liquids in the vicinity of this or any other appliance.
- **WHAT TO DO IF YOU SMELL GAS**
 - Do not try to light any appliance.
 - Do not touch any electrical switch; do not use any phone in your building.
 - Leave the building immediately.
 - Immediately call your gas supplier from a neighbor's phone. Follow the gas supplier's instructions.
 - If you cannot reach your gas supplier, call the fire department.
- Installation and service must be performed by a qualified installer, service agency or the gas supplier.

**NATIONAL
FIREPLACE
INSTITUTE**



CERTIFIED
www.nficertified.org

Our gas hearth products must be installed and serviced by professionals who are certified in the U.S. by the National Fireplace Institute® (NFI) as NFI Gas Specialists.

LOG SET

MODEL:

LS34BIN

For Use With

DVCP34BN91 Inserts

GAS-FIRED



NOTICE: Ceramic logs may differ in appearance from those shown in this manual.

⚠ WARNING

If not installed, operated and maintained in accordance with the manufacturer's instructions, this product could expose you to substances in fuel or from fuel combustion which can cause death or serious illness.

IMPORTANT

THANK YOU for purchasing this log set!

We take pride in building high-quality systems with realistic hand-painted logs and natural looking flame. Immediately after installation, check for proper position of the log set, embers kit, and embers (if equipped).

- Are the glowing ember (pieces) evenly distributed and positioned over the correct ports?
- Is the flame lively and natural looking?
- Are the logs clean looking and out of the direct path of the flickering flames?

To help ensure years of trouble-free service, please check your log set again after using it for two weeks, and shortly after each start of each heating season thereafter. If you notice any of the following, call your dealer or installer.





- Weak flames
- Uneven distribution of embers
- Build up of ash or soot on logs

NOTE: These logs are designed to fit together one way. Do not reposition the logs or add log pieces. Doing so will affect the flame pattern and may cause improper burning.

NOTICE: Contact your dealer for installation, service, repair, or warranty claim

Empire Comfort Systems does not sell, service, or provide warranty directly to consumers. The consumer must contact the dealer where the product was purchased for a warranty claim. If a non-qualified installer or consumer installs or services this product, the product warranty is voided. Most dealers will only service products they sold so it is important for the consumer to choose a qualified dealer for installation and warranty service. In order to maintain the warranty, service must be performed annually and documentation reviewed during the warranty request.

LOG IDENTIFICATION

DVCP34 PART#	FRONT	TOP
R13854	 Log (A)	 Log (A)
R13855	 Log (B)	 Log (B)
R13856	 Log (C)	 Log (C)
R13857	 Log (D)	 Log (D)
R13858	 Log (E)	 Log (E)
R13859	 Log (F)	 Log (F)

USE ONLY MANUFACTURER'S REPLACEMENT PARTS. USE OF ANY OTHER PARTS COULD CAUSE INJURY OR DEATH.

Attention: When ordering parts, it is very important that **part number** and **description** of part coincide.

LOG AND EMBER PLACEMENT

NOTE: Install liners before logs. See separate Liner Installation manual for details.

⚠ CAUTION

Do not handle these logs with your bare hands. Always wear gloves to prevent skin irritation from ceramic fibers. After handling the logs, wash your hands gently with soap and water to remove any trace of fibers.

Accessing the Interior of the Insert

See Homeowners Manual for instruction on how to remove the barrier screen and glass door.

Log Set Installation

The positioning of the logs is critical to the safe and clean operation of this insert. Sooting and other problems may result if the logs are not properly and firmly positioned in the insert. Please refer to (Figure 1) and the following **WARNING** when completing log placement instructions. (See Pages 5 - 14).

⚠ WARNING

Failure to position the parts in accordance with this diagram or failure to use only parts specifically approved with this insert may result in property damage or personal injury.

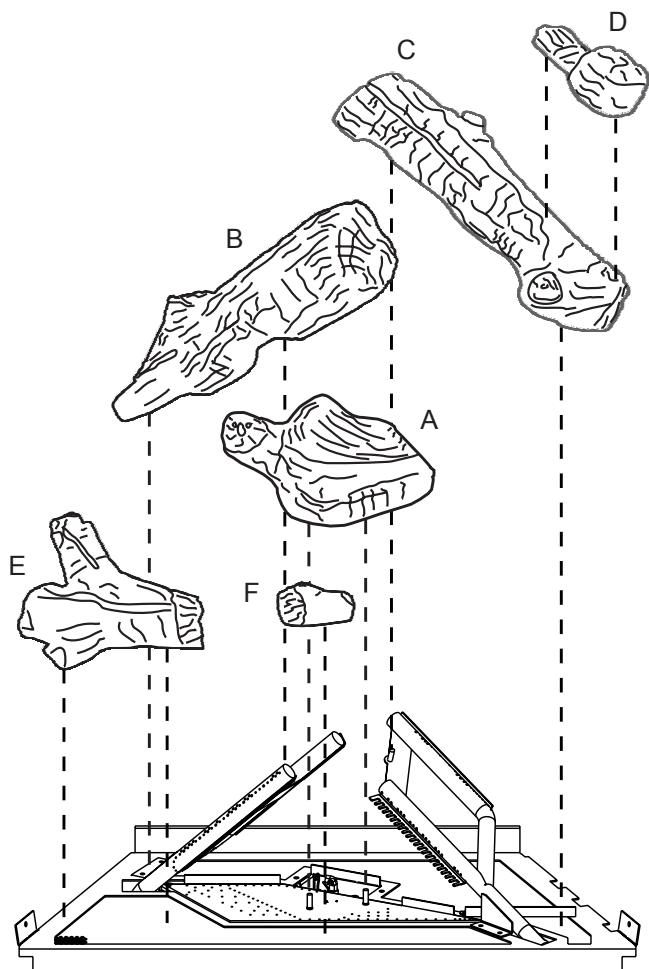

Figure 1

Burner Base Pin Location

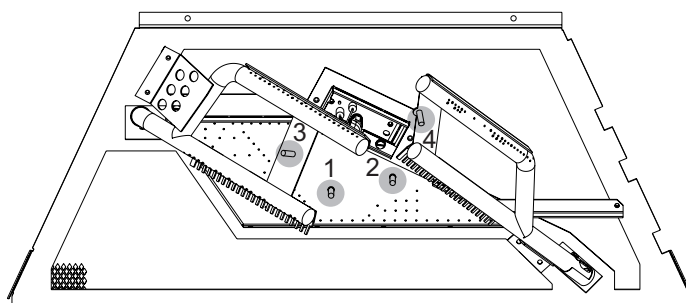

Figure 2

Glowing Embers Information

1. Carefully separate the ember material into small amounts (no larger than "dime-size" pieces).
 - a. Fluffed up pieces of ember material one layer thick will produce the best ember glow. Do not place more than one layer of ember material onto the burner. Excess ember material will decrease the ember glow effect.
 - b. Save any remaining ember material for future applications (as needed).
 - c. Left and Right burners removed from Figure 3 for clarity. Add embers as shown below.

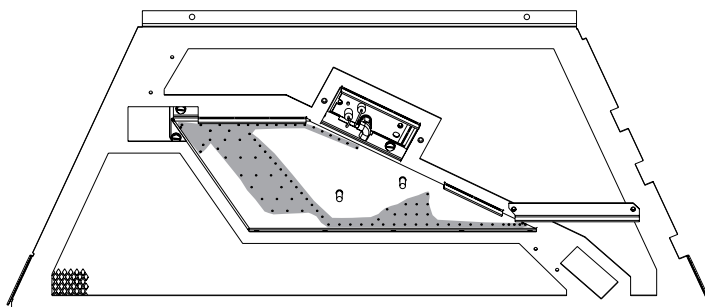

Figure 3

- d. Continue adding embers to Left and Right burner as shown in Figure 4.

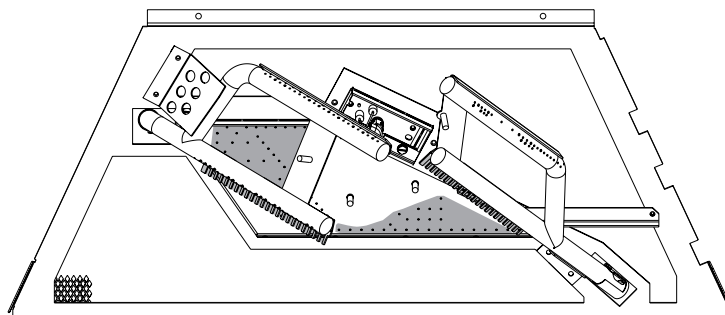
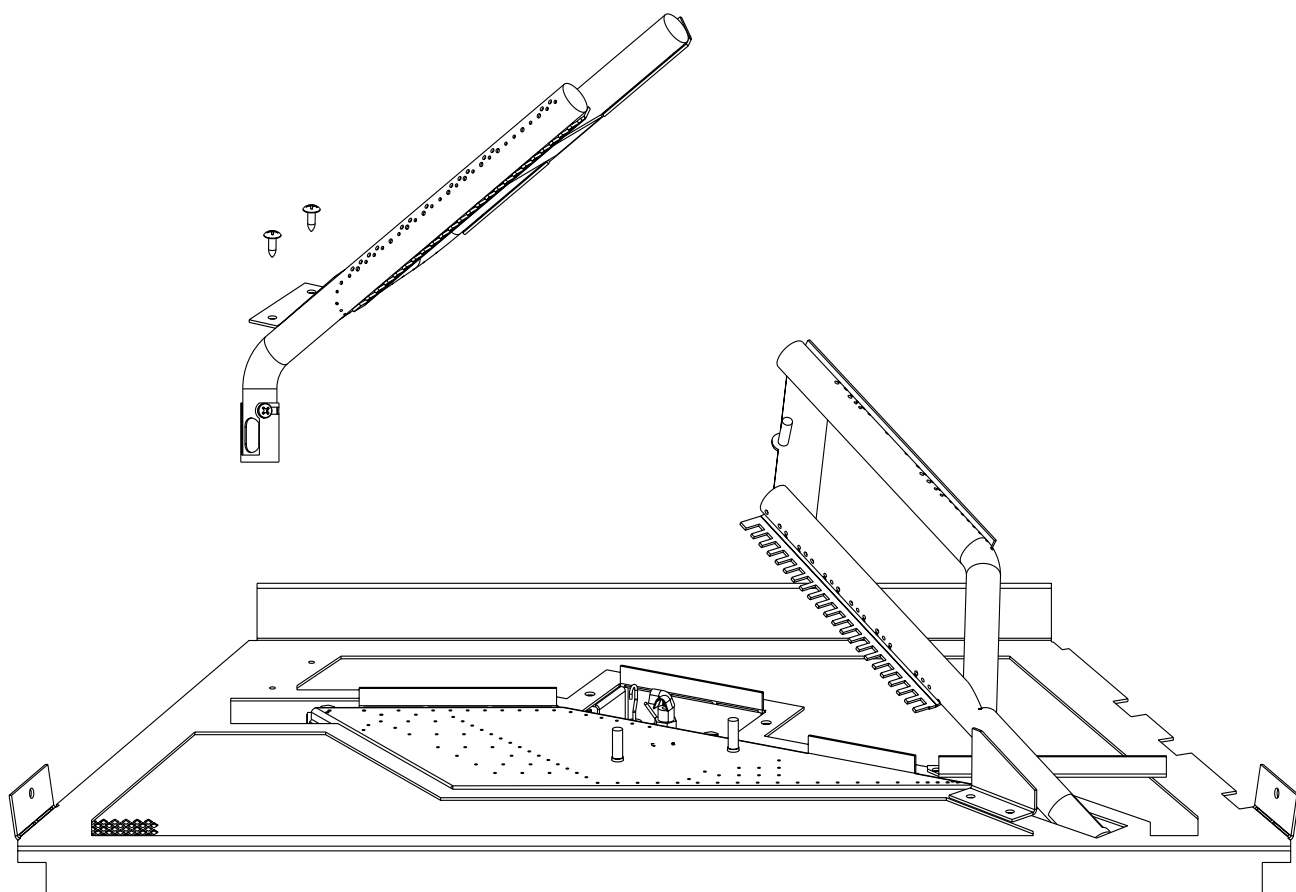

Figure 4

LOG AND EMBER PLACEMENT

1. Remove **Left Burner** by removing 2 screws, securing burner to base as shown.



FRONT

LOG PLACEMENT

2. Place **Decorative Glass** onto burner base as shown. Place **Embers** onto center burner as shown.

NOTE: Carefully separate the Ember material into small amounts (no larger than “dime-size” pieces).



TOP



FRONT

LOG PLACEMENT

3. Place **Log (A)** onto center burner located by **Pins 1 and 2** as shown.



TOP

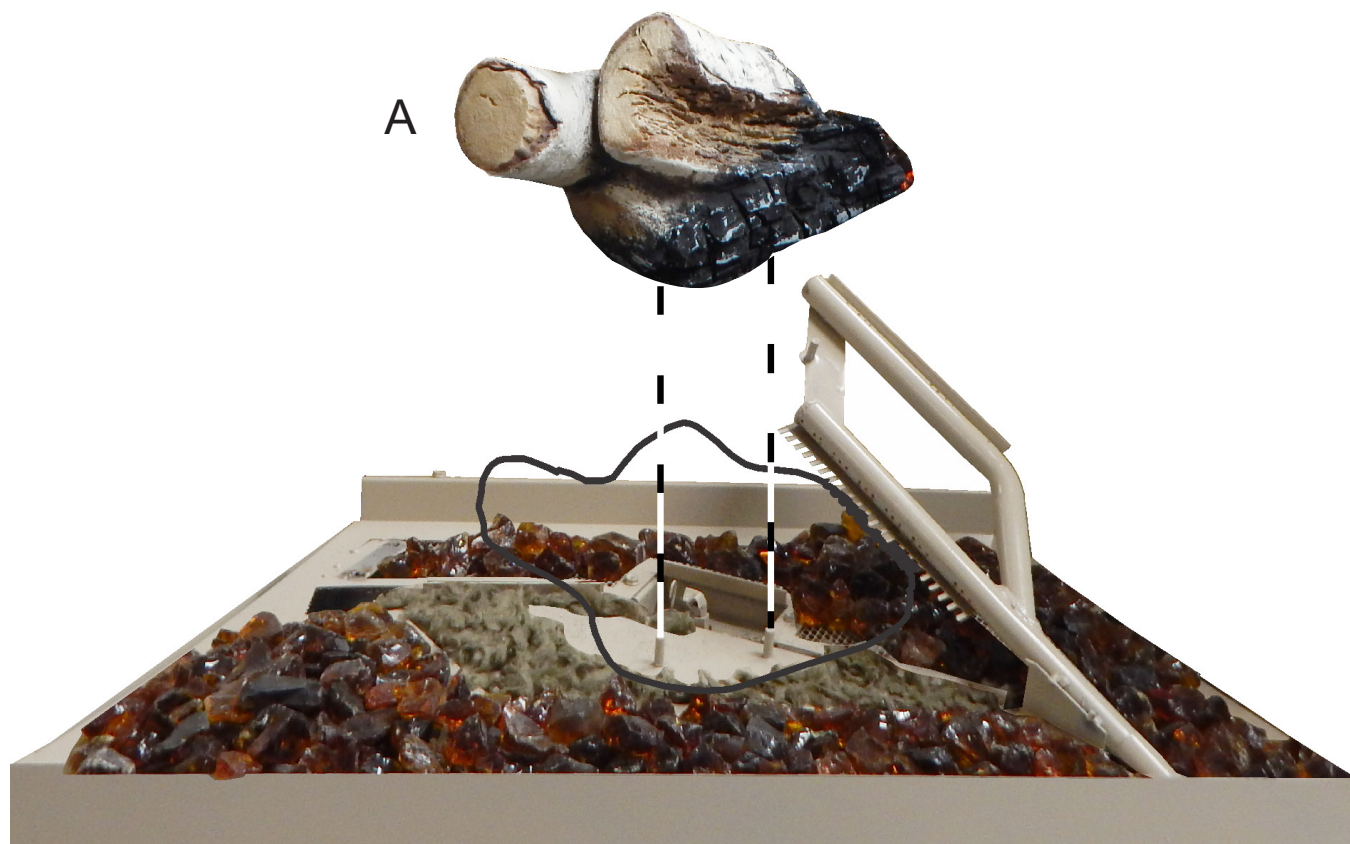

FRONT

LOG PLACEMENT

4. Replace **Left Burner** removed in first step, as shown.



TOP



FRONT

LOG PLACEMENT

5. Place **Embers** on **Left and Right Burners** as shown.

NOTE: Carefully separate the Ember material into small amounts(no larger than “dime-size” pieces). Place Embers on top of Ember Retainer Bracket attached to front of tubes as shown.



TOP



FRONT

LOG PLACEMENT

6. Place **Log (B)** onto **Left Burner**, located by **Pin 3** as shown.



TOP

B

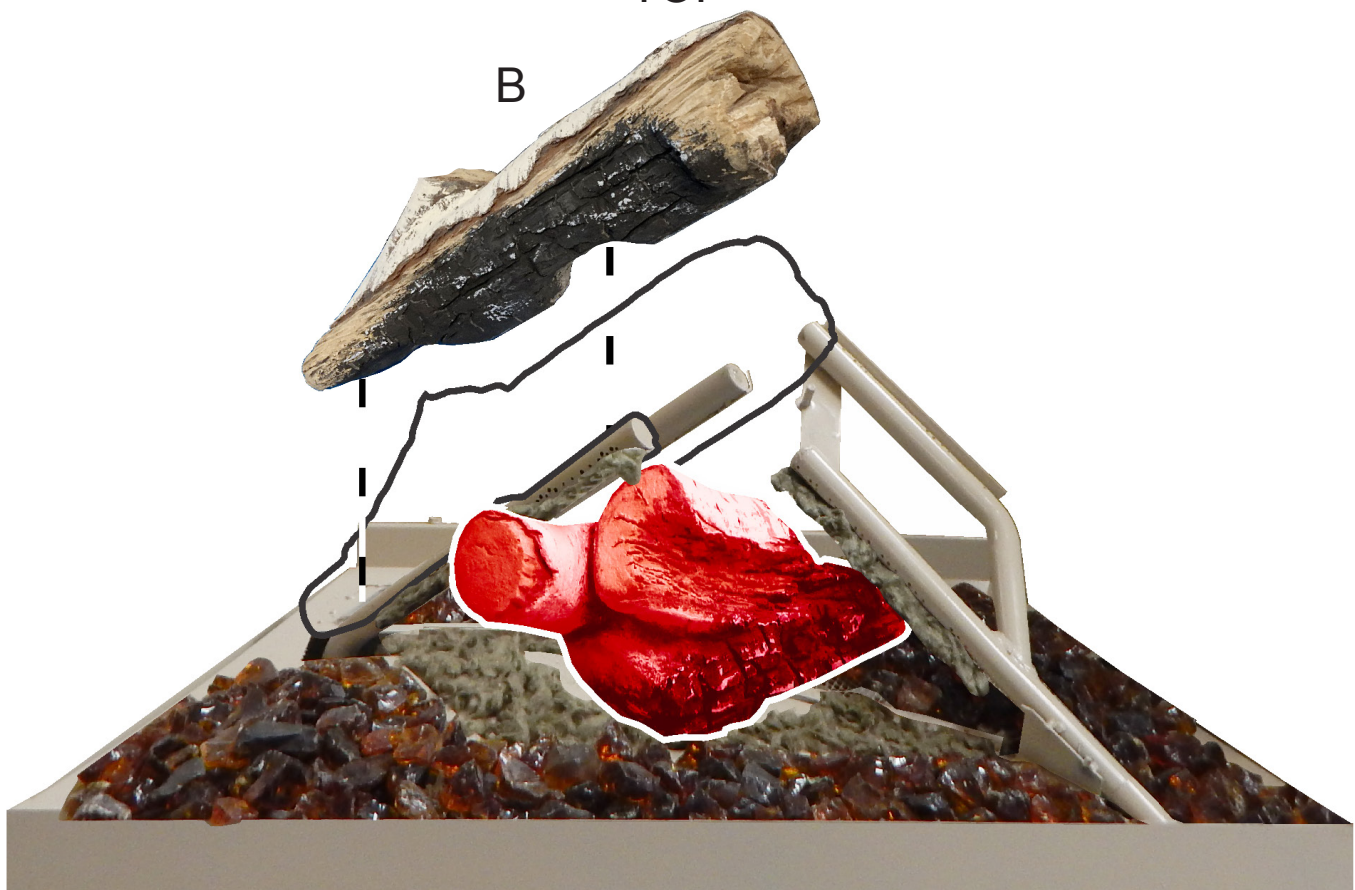

FRONT

LOG PLACEMENT

7. Place **Log (C)** onto **Right Burner**, located by **Pin 4** as shown.

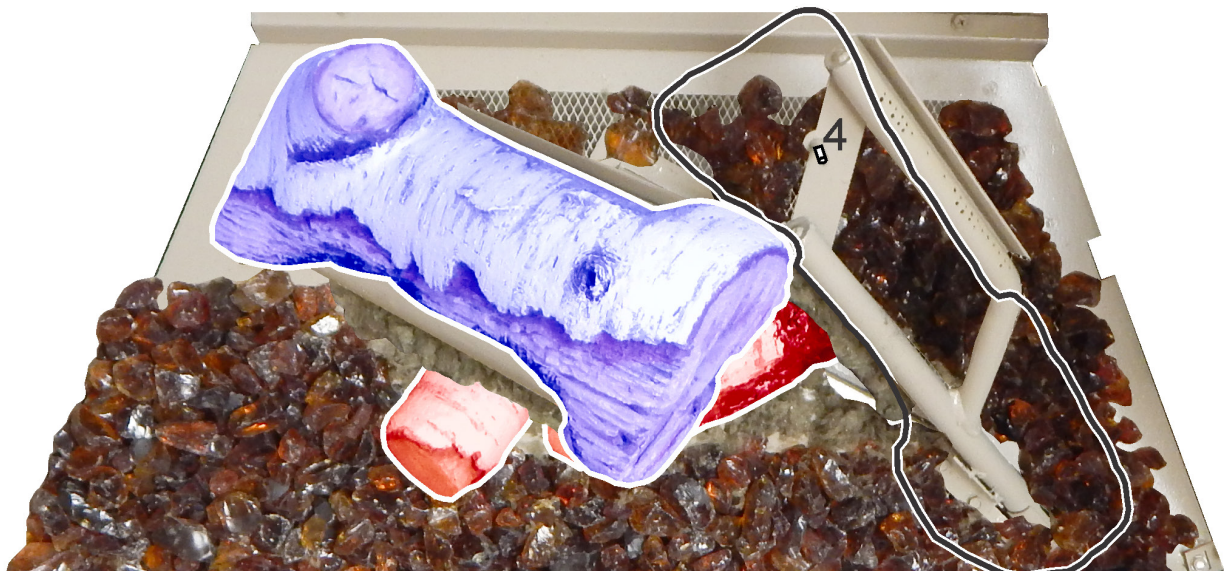

TOP

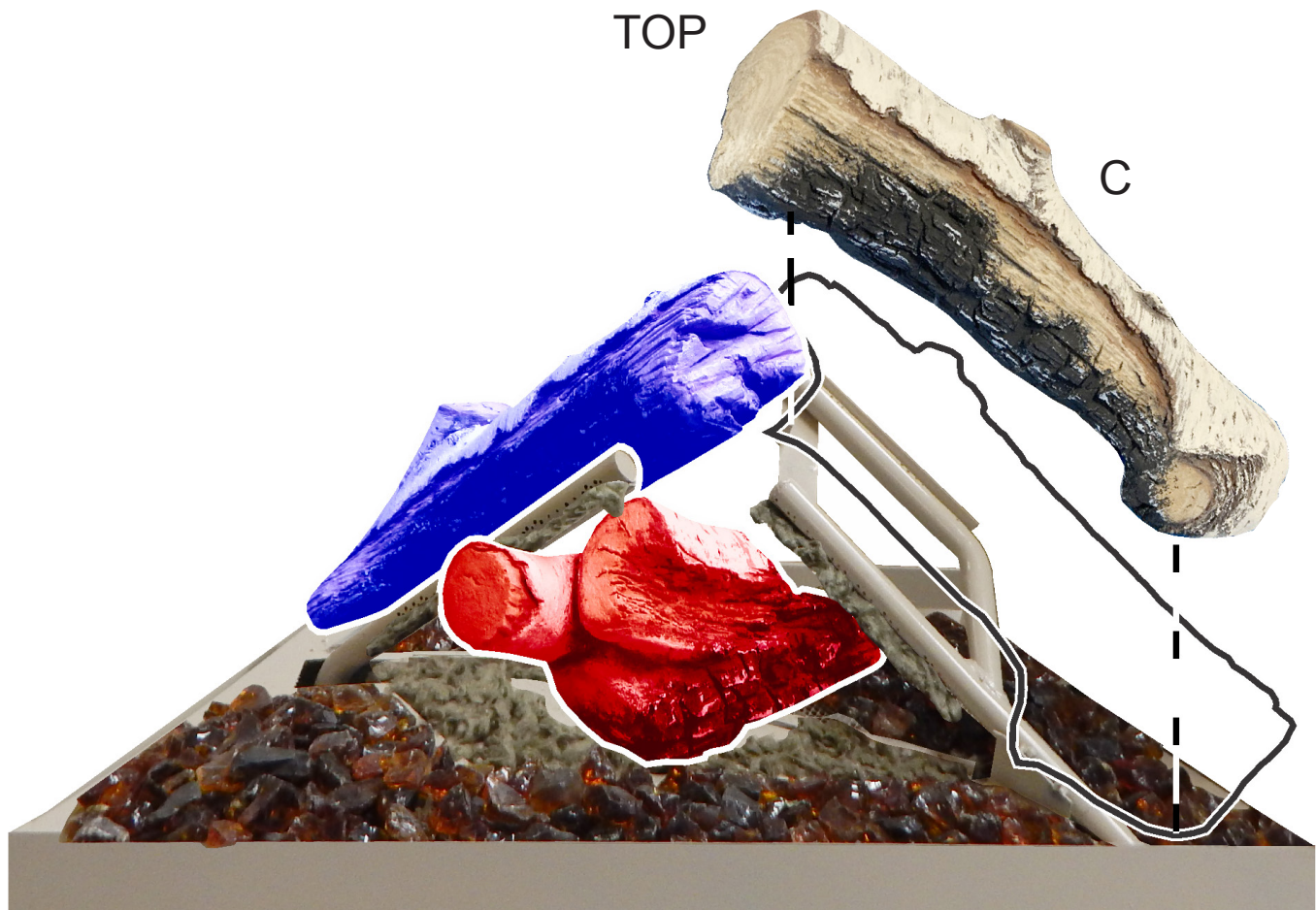

FRONT

LOG PLACEMENT

8. Place **Log (D)** onto **Log (C)**, and rests on right side as shown.



TOP



FRONT

LOG PLACEMENT

9. Place **Log (E)** onto burner base as shown.



TOP



FRONT

LOG PLACEMENT

10 Place **Log (F)** onto burner base as shown.



TOP

F



FRONT

LOG PLACEMENT

11. Log assembly is **Complete**.



TOP



FRONT

MASTER PARTS DISTRIBUTOR LIST

To Order Parts Under Warranty, please contact your local Empire dealer. See the dealer locator at www.empirecomfort.com. To provide warranty service, your dealer will need your name and address, purchase date and serial number, and the nature of the problem with the unit.

To Order Parts After the Warranty Period, please contact your dealer or one of the Master Parts Distributors listed below. This list changes from time to time.

Please note: Master Parts Distributors are independent businesses that stock the most commonly ordered Original Equipment repair parts for Heaters, Grills, and Fireplaces manufactured by Empire Comfort Systems Inc.

Dey Distributing

1401 Willow Lake Boulevard
Vadnais Heights, MN 55101

Phone: 651-490-9191

Toll Free: 800-397-1339

Website: www.deydistributing.com

Parts: Heater, Hearth and Grills

F. W. Webb Company

200 Locust Street
Hartford, CT 06114

Phone: 860-722-2433

Toll Free: 800-243-9360

Fax: 860-293-0479

Toll Free Fax: 800-274-2004

Website: www.fwwebb.com

Parts: Heater, Hearth and Grills

East Coast Energy Products

10 East Route 36
West Long Branch, NJ 07764

Phone: 732-870-8809

Toll Free: 800-755-8809

Fax: 732-870-8811

Website: www.eastcoastenergy.com

Parts: Heater, Hearth and Grills

HOW TO ORDER REPAIR PARTS

Parts Not Under Warranty

Parts can be ordered through your Service Person, Dealer, or a Master Parts Distributor. See this page for the Master Parts Distributors list. For best results, the **service person or dealer** should order parts through the distributor. Parts can be shipped directly to the **service person/dealer**.

Warranty Parts

Warranty parts will need a proof of purchase and can be ordered by your Service Person or Dealer. Proof of purchase is **required** for warranty parts.

All parts listed in the Parts List have a Part Number. When ordering parts, first obtain the Model Number and Serial Number from the name plate on your equipment. Then determine the Part Number (**not** the Index Number) and the Description of each part from the following illustration and part list. Be sure to give all this information . . .

Appliance Model Number _____ Part Description _____

Appliance Serial Number _____ Part Number _____

Type of Gas (Propane or Natural) _____

Do not order bolts, screws, washers or nuts. They are standard hardware items and can be purchased at any local hardware store.

Shipments contingent upon strikes, fires and all causes beyond our control.



SINCE 1932

Empire Comfort Systems Inc.
Belleville, IL

If you have a general question
about our products, please e-mail
us at info@empirecomfort.com.

If you have a service or repair
question, please contact your dealer.

www.empirecomfort.com