

INSTALLATION INSTRUCTIONS DECORATIVE FIREPLACE FRAME

DVCP34BN91 - DECORATIVE FRAME MODELS:

DECORATIVE (BEVELED) FRAME		DECORATIVE (FORGED IRON) FRAME	
Finish	Model Number	Finish	Model Number
Black	DFB34BL	Black	DFI34BL
Oil-Rubbed Bronze	DFB34BZ	Oil-Rubbed Bronze	DFI34BZ
Distressed Pewter	DFB34BN	Distressed Pewter	DFI34DP

CLEANING

With the unit turned off and cool to the touch, use a 50/50 solution of vinegar and water and a clean soft cloth to remove dirt and fingerprints. Clean frame before and after start-up and again anytime oil or fingerprints are present. When heated, oil from fingerprints or left over from manufacturing can permanently discolor the plating.

INSTALLATION

Slide the decorative front onto the glass frame over the barrier screen so the hooks hang on the four notches.

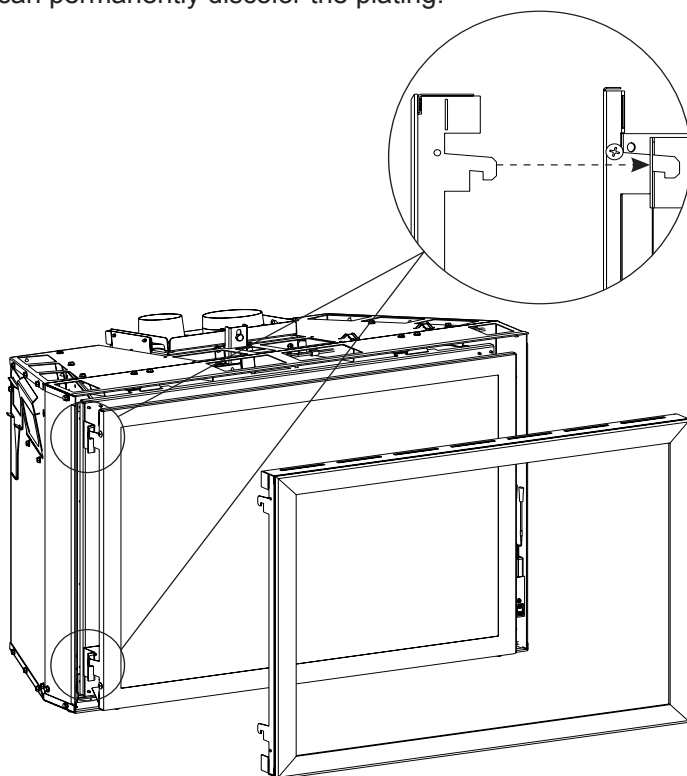

**Beveled
Frame Shown**

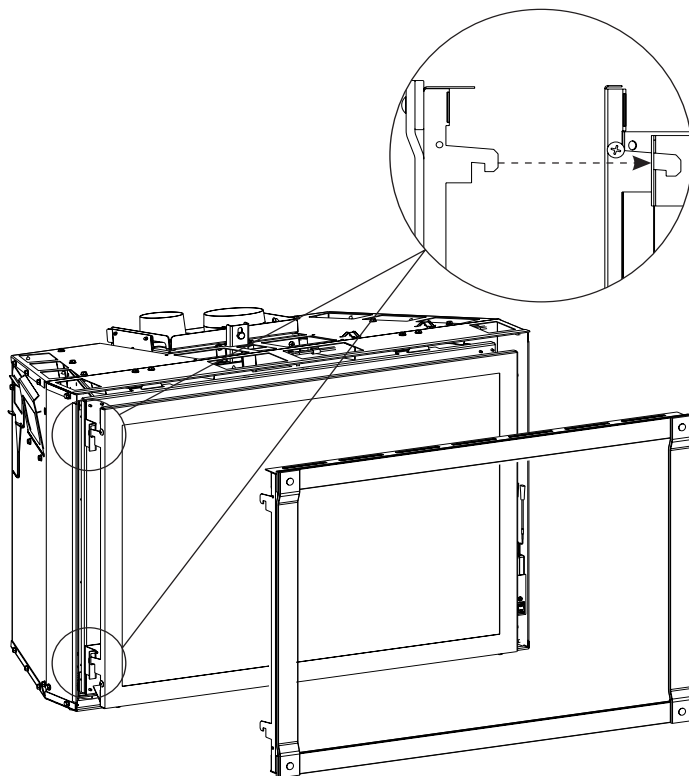

**Forged
Iron Frame Shown**

NOTICE: Contact your dealer for installation, service, repair, or warranty claim

Empire Comfort Systems does not sell, service, or provide warranty directly to consumers. The consumer must contact the dealer where the product was purchased for a warranty claim. If a non-qualified installer or consumer installs or services this product, the product warranty is voided. Most dealers will only service products they sold so it is important for the consumer to choose a qualified dealer for installation and warranty service. In order to maintain the warranty, service must be performed annually and documentation reviewed during the warranty request.



SINCE 1932

Empire Comfort Systems Inc.
Belleville, IL

If you have a general question
about our products, please e-mail
us at info@empirecomfort.com.

If you have a service or repair
question, please contact your dealer.

www.empirecomfort.com