



OMNI-Test Laboratories, Inc.  
Report #280-G-05b-5

- 51-05 Largo Fire Pit
- 51-09 Santorini Fire Pit
- 51-18 Vulsini Fire Pit



OWNER'S MANUAL

Tested & Certified to  
ANSI Z21.97-2012/CSA2.41-2012  
CGA 2.17-M91 (R2009)

# CASUAL FIRESIDE™

A HIGHER STANDARD IN QUALITY AND APPEARANCE - SAFE AND BEAUTIFUL OUTDOOR FIRE PIT FOR PROPANE AND \*NATURAL GAS



 **WARNING: FOR OUTDOOR USE ONLY**

\*Needs conversion kit

**CODE AND SUPPLY REQUIREMENTS:** When an appliance is for connection to a fixed piping system, the installation must conform with local codes, or in the absence of local codes with the National Fuel Gas Code ANSI Z223.1/NFPA 54, OR International Fuel Gas Code.

 **WARNING**  
**Do not store or use gasoline or other flammable vapors and liquids in the vicinity of this or any other appliance.**

**An LP-cylinder not connected for use shall not be stored in the vicinity of this or any other appliance.**

 **WARNING**  
**Improper installation, adjustment, alteration, service or maintenance can cause injury or property damage. Read the installation, operating and maintenance instructions thoroughly before installing or servicing this equipment.**

 **DANGER**

If you smell gas:

1. Shut off gas to the appliance.
2. Extinguish any open flame.
3. If odor continues, keep away from the appliance and immediately call your gas supplier or fire department.

**This appliance is designed as an "attended appliance". Adults must be present when the unit is operating. DO NOT leave this unit burning when unattended. If this product is left burning unattended it may cause damage or serious injury.**

 **DANGER**

**CARBON MONOXIDE HAZARD**

This appliance can produce carbon monoxide which has no odor.

Using it in an enclosed space can kill you.

Never use this appliance in an enclosed space such as a camper, tent, car, or home.

**INSTALLER** - Owner's Manual must be left with the consumer for future reference.  
**CONSUMER** - Owner's Manual must be saved for future reference.

## O.W. LEE OUTDOOR FIRE PIT– TABLE OF CONTENTS

Cover – Important Safety Information.....	1
Table of Contents.....	2
Important Safety Information	
Minimum Clearances to Combustibles.....	2
Pre-Installation & Preparation Guidelines.....	3
Installation Information	
Connecting the Gas to the Fire Pit.....	5
Parts List.....	6
Lava Granule & Glass Crystal Placement.....	6
Operating Instructions.....	7
Lighting Instructions.....	7
Operating Information.....	4
Conversion for High Altitude or Conversion to a Different Gas Type.....	8

### IMPORTANT SAFETY INFORMATION

#### READ THESE INSTRUCTIONS FULLY BEFORE INSTALLING THIS OUTDOOR FIRE PIT

If not installed and used correctly per these instructions, this product can cause serious injury.

**CAUTION: INSTALLATION, MODIFICATION AND REPAIR MUST BE DONE BY A QUALIFIED, PROFESSIONAL INSTALLER.**

Be sure you understand all safety precautions and warnings contained in this manual.

- A. CHECK STATE AND LOCAL CODES TO DETERMINE IF THE OUTDOOR FIRE PIT IS PERMITTED IN YOUR LOCALITY BEFORE INSTALLATION.
- B. FOR OUTDOOR USE ONLY. THIS UNIT MUST BE INSTALLED AT LEAST 60" FROM CENTER OF BURNER TO ANY COMBUSTIBLE WALLS, CEILINGS, OR MATERIAL.
- C. When shutting the unit down—be sure to TURN THE CONTROL VALVE FULLY OFF.
- D. **WARNING: CARBON MONOXIDE POISONING MAY LEAD TO DEATH. DO NOT MODIFY THIS OUTDOOR FIRE PIT OR ITS CONTROLS, EXCEPT AS PROVIDED FOR IN THIS MANUAL.**

Any other change may be dangerous. Improper installation or use of your Outdoor Fire Pit can cause serious injury or death from fire, burns, explosions or carbon monoxide poisoning.

### MINIMUM CLEARANCE TO COMBUSTIBLES

**NOTE**

MINIMUM OF 60" (1.5 m) CLEARANCE ABOVE THE OUTDOOR FIRE PIT IF INSTALLED UNDER CEILING OR OVERHANG



FIGURE 1

#### Clearances to Combustible Construction:

- Sidewalls: 60" (1.5 m) from center of unit (Figure 1)
- Ceiling: 60" (1.5 m) from top of unit to ceiling or overhang
- Flooring: 0" – Can be installed on deck, slab, floor, etc.

The dimensions shown in Figure 1 are **MINIMUM CLEARANCES** to maintain when you install this Outdoor Fire Pit. **THERE MUST BE AT LEAST 60" of clearance from the center of the unit** to any combustible sidewalls, ceilings, or material.

## IMPORTANT SAFETY INFORMATION

### PRE-INSTALLATION AND PREPARATION SAFETY GUIDELINES

- A. Before installing this Outdoor Fire Pit, check “Minimum Clearance to Combustibles” on page 2. **MINIMUM CLEARANCES** must be maintained when you install this Outdoor Fire Pit. **THERE MUST BE AT LEAST 60”** (1.5 m) from the center of the burner to any combustible sidewall, ceiling, or material.
- B. The Outdoor Fire Pit is for outdoor use only. **DO NOT** install or use this appliance inside a building, garage, or any other enclosed area including recreational vehicles and/or boats. **This unit must be installed in such a manner that proper air ventilation is maintained without obstruction at all times, and during all weather conditions.**
- C. **CHECK GAS TYPE** (natural gas or propane): The gas supply you intend to use may not be the same as that stated on your outdoor rating plate. **THIS FIRE PIT IS CONSTRUCTED FOR USE WITH PROPANE GAS.** If the gas supply is different, or **or you wish to change to natural gas, you MUST have the Fire Pit converted (method described on page 8) to the gas type you intend to use, by a qualified, professional installer.** If you are unsure, contact your dealer for assistance.
- D. **DO NOT USE IF GAS PRESSURE IS LOWER THAN THE MINIMUM REQUIREMENT OR EXCEEDS THE MAXIMUM.**
- E. **FOR NATURAL GAS:** The minimum inlet gas supply pressure for purposes of input adjustment is **5 inches** (127 mm) water column and maximum inlet gas supply pressure is **10 inches** (254 mm) water column. **FOR PROPANE:** The minimum inlet gas supply pressure for purposes of input adjustment is **8 inches** (203 mm) water column and the maximum inlet gas supply pressure is **13 inches** (330 mm) water column. **DO NOT INSTALL THIS UNIT IF MINIMUM PRESSURE IS NOT AVAILABLE OR IF MAXIMUM PRESSURE IS EXCEEDED.**
- F. Gas piping system must be sized to provide minimum inlet pressure at the maximum flow rate (BTU/hr). Undue pressure loss will occur if the pipe is too small or the run is too long.
- G. For installations at elevations above 2,000 ft., contact your local dealer or gas supplier before installing as input ratings will be reduced approximately 4% for each 1,000 ft. above sea level. Refer to the National Fuel Gas Code. **Contact the dealer for the required orifice** (Also see page 8 of instructions).
- H. If the Outdoor Fire Pit is connected to Natural Gas, its main gas valve must be disconnected from the gas supply piping system during any pressure testing of that system at test pressures in excess of ½ psi (3.5kPa).
- I. If the Outdoor Fire Pit is connected to Natural Gas, it must be isolated from the gas supply piping system by closing its individual manual shut-off valve during any pressure testing of the gas supply piping system at test pressures equal to or less than ½ psi (3.5kPa).
- J. **INSTALLER NOTE: This unit should be installed so that it can be removed at a later date for service.**
- K. **GAS SUPPLY PLUMBING REQUIREMENTS**  
Apply only joint compounds that are resistant to all gasses on all male pipe fittings. Make sure to tighten every joint securely. Do not use pipe joint compound to connect flare fittings.

**SAFETY NOTE: An external on/off valve in the gas line is required for safety when your Outdoor Fire Pit is not in use. It also provides for convenient maintenance and repair.**

## IMPORTANT SAFETY INFORMATION

### OPERATING INSTRUCTIONS

- A. **YOUNG CHILDREN SHOULD BE CAREFULLY SUPERVISED WHEN THEY ARE IN THE AREA OF THIS APPLIANCE.**
- B. **DO NOT sit or place any part of the body or combustible materials on the Fire Pit surround. Children and adults should be alerted to the hazard of high surface temperatures and should stay away to avoid burns or clothing ignition.**
- C. Every time you use your Fire Pit make sure that the area around the Fire Pit is clear of flammable items such as gasoline, yard debris, wood, etc.
- D. **WARNING: HOT WHILE IN OPERATION AND FOLLOWING OPERATION.** Children must be carefully supervised when in the vicinity of this appliance. Serious injury may occur. **DO NOT** throw trash, paper, or other flammable materials onto your Fire Pit. **DO NOT** leave in operation when unattended. **WARNING: DO NOT operate this Fire Pit in the rain.**
- E. SOLID FUEL MUST NOT BE BURNED in the Fire Pit.
- F. **DO NOT** continue using if you smell unusual odors or have headaches, nausea or are dizzy.
- G. **DO NOT** store any combustible materials, gasoline, or any other flammable vapors/liquids around the area of your Fire Pit. Provide adequate clearance for servicing and operation.
- H. **Clothing or other flammable materials should not be hung from the appliance, or placed on or near the appliance.** Matches, paper, garbage, or any other material must not be thrown on top of the lava rock, logs, or burner, or into the flame.
- I. **DO NOT use this appliance if any part of it has been under water.** Immediately call a qualified service technician to inspect the appliance and to replace any part of the control system and any gas control which has been under water.
- J. **Installation and repair should be done by a qualified service person.** Open the door on the unit to gain access for inspection.
- K. **The appliance should be inspected before use and at least annually by a qualified service person.** More frequent cleaning may be required as necessary. It is imperative that control compartment, burners and circulating air passageways of the appliance be kept clean.
- L. The burner must be replaced prior to the appliance being put into operation if it is evident that the burner is damaged. Replacement burner #FC-B200 manufactured by Formation Creation Inc. 17205 Eucalyptus #B10, Hesperia, CA 92345.
- M. Periodically make a visual check of the burner flames - see pictorial representation below for proper flame height
- N. Cleaning of appliance – Remove lava rock or glass crystals, clean burner with soap and water and dry thoroughly. Clean lava rock or glass crystals with water and dry thoroughly before lighting.



Pictorial representation of approximate flame height.

## INSTALLATION INFORMATION CONNECTING THE GAS TO THE FIRE PIT

### IMPORTANT

**BEFORE PROCEEDING, CAREFULLY READ ALL OF THE IMPORTANT SAFETY INFORMATION CONTAINED IN THIS OWNER'S MANUAL, INCLUDING:**

- A. Pre-Installation and Outdoor Fire Pit Preparation Safety Guidelines (page 3).
- B. Log Installation Guidelines (Page 5).
- C. Minimum Clearance to Combustibles (page 2).

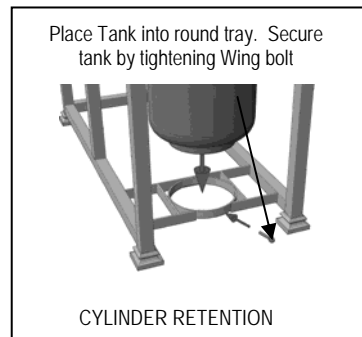

### LP-GAS CYLINDER INFORMATION:

1. Cylinder Size: 20 Lbs. (9kg) Capacity: 4.7 Gallons (17.8 Liters).
2. The LP-gas cylinder(s) to be used must be constructed and marked in accordance with the U.S. Department of Transportation (D.O.T.) Specifications for LP-Gas Cylinders or the Standard for Cylinders, Spheres and Tubes for Transportation of Dangerous Goods and Commission, CAN/CSA-B339 as applicable.  
--Use propane cylinders approved for your area such as "Blue Rhino" or "AmeriGas" with this appliance. Other cylinders may be acceptable for use with the appliance provided they can be mounted to the appliance using the cylinder retention device provided. (See illustration above.)  
--The LP-gas supply cylinder to be used must be provided with a listed overfilling prevention device and with a cylinder connection device compatible with the connection for the appliance.
3. If the appliance is not in use, the gas must be turned off at the supply cylinder.
4. The cylinder must be disconnected when the appliance is not in use.
5. The LP-gas cylinders must be stored outdoors in a well-ventilated area out of the reach of children. Disconnected cylinders must have threaded valve plugs tightly installed and must not be stored in a building, garage, or any other enclosed area.
6. The cylinder supply system must be arranged for vapor withdrawal.
7. The cylinder used must include a collar to protect the cylinder valve.

### BEFORE INSTALLATION, BE SURE THE PROPANE TANK IS TURNED OFF.

To connect to the propane gas tank, attach the black hose (with regulator) and tighten down the connector. Follow all instructions and safety warnings supplied with the propane tank. (See diagram below.)

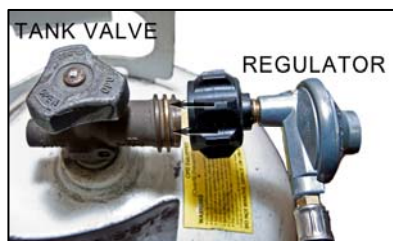

Turn on the gas to the burner system and test for leaks with soapy water solution.

**(Never use an open flame for testing). If a leak is found, tighten the connector until no leaks are detected.**

The hose and burner should be inspected before each use of the appliance.

The hose assembly must be replaced prior to the appliance being put into operation if there is evidence of excessive abrasion or wear, or if the hose is damaged. The replacement hose shall be that specified by the manufacturer.

## LAVA GRANULE & GLASS CRYSTAL INSTALLATION GUIDELINES

- A. Carefully inspect the carton for shipping damage. If any parts are missing or damaged, call your dealer. **Do not attempt** to install the appliance unless all parts are in good condition.
- B. Correct installation is crucial to safe performance of your Outdoor Fire Pit.
- C. Due to high temperatures, the Fire Pit must be located out of traffic areas and away from combustibles.

### PARTS LIST

Replacement parts available from your local retailer



Bag of Lava Rock or Glass Crystals

- #1 Stainless Steel Rectangle Burner Kit
- #2 Regulator with Hose
- #3 On/Off Control Knob
- #4 Flex Hose
- #5 Brass Replacement Valve
- #6 Propane Cylinder Connector
- #7 Orifice
- #8 Propane to Natural Gas Conversion Kit
- #9 Natural Gas to Propane Conversion Kit

#### Approved Media:

- #10 Ceramic Rock Kit with Lava Granules
- #11 Tumbled Fire Glass Kit – Size #3 3/8" – 1/2" (9-12 mm)
- #12 Ceramic Log Kit with Lava Granules
- #13 Lava Granules 3/8"
- #14 Pebble Fire Glass Kit – Size #3 3/4" – 1/2" (9-19mm)
- #15 Ceramic Sphere Kit with Lava Granules

## LAVA GRANULE & GLASS CRYSTAL PLACEMENT

Pour the bag of lava granules, glass crystals or other approved media into the Outdoor Fire Pit so that the burner is completely covered. (See parts list above for approved media.)

(See figures #1 and #2)

Top View

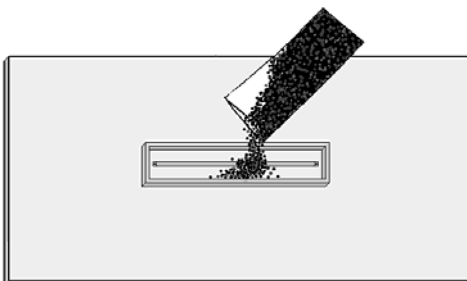

Figure 1

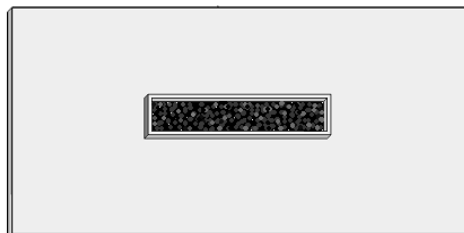

Figure 2

**CAUTION: BURN HAZARD. LAVA GRANULES AND GLASS CRYSTALS WILL REMAIN HOT FOR SOME TIME AFTER USE. YOU MUST MAINTAIN THE LAYOUT AS SHOWN TO ENSURE PROPER OPERATION OF YOUR FIRE PIT. IF YOU NEED TO REPOSITION ANY MATERIAL TO MAINTAIN THE PROPER LAYOUT, USE HEAT RESISTANT GLOVES OR ALLOW MATERIAL ADEQUATE TIME TO COOL BEFORE HANDLING.**

# OPERATING INSTRUCTIONS

*\*We recommend that before you install your Fire Pit you familiarize yourself with the control valve layout. This will help you to be confident operating the Fire Pit when fully installed (see figures below for typical control positions).*

## FOR YOUR SAFETY, READ BEFORE LIGHTING

**WARNING: IF YOU DO NOT FOLLOW THESE INSTRUCTIONS EXACTLY, A FIRE OR EXPLOSION MAY RESULT CAUSING PROPERTY DAMAGE, PERSONAL INJURY OR LOSS OF LIFE.**

**BEFORE LIGHTING**, smell all around the Outdoor Fire Pit area for gas. Be sure to smell next to the floor because some gas is heavier than air and will settle on the floor. **IF YOU SMELL GAS FOLLOW THE INSTRUCTIONS ON PAGE 1.**

Use only your hand to push in or turn the gas control knob. Never use tools. If the knob will not push in or turn by hand. **DO NOT** try to repair it. Call a qualified, professional service technician. Force or attempted repair may result in fire or explosion.

**DO NOT** use this appliance if any part has been under water. Immediately call a qualified, professional service technician to inspect the Outdoor Fire Pit and to replace any part of the control system and any gas control that has been under water.

## LIGHTING INSTRUCTIONS

### STOP – READ SAFETY INFORMATION ABOVE.

1. Push in the manual gas control knob slightly and turn clockwise to the “OFF” position.
2. Wait 5 minutes for gas to clear out.
3. Place a burning match to the surface of the lava granules that cover the burner. Do not hold the match by hand.
4. After the match is burning and in position, push in the manual gas control knob slightly, and slowly turn the knob counter-clockwise to the “ON” position.



### Shutting Off the Fire Pit

To turn off: Press in and rotate the manual gas control knob clockwise to the “OFF” position.

**CAUTION:**  
**DO NOT** turn the main gas valve knob to the “ON” position **FOR 5 MINUTES** after shutting the unit off.

# CONVERTING YOUR FIRE PIT TO A DIFFERENT GAS TYPE (OR TO CONVERT FOR HIGH ALTITUDE\*)

To convert your Fire Pit from propane to natural gas or natural gas to propane gas, carefully follow the steps below: **(Conversion Kit with proper orifice to convert burner to natural gas is included in instruction packet.)**

1. **MAKE SURE THAT THE GAS SUPPLY TO THE FIRE PIT (AND ANY NEARBY ELECTRICAL SOURCES/APPLIANCES) ARE SHUT OFF.**
2. Carefully detach the connector hose attached to the orifice holder (Figure # 1) and unscrew the orifice holder from the burner pipe (Figures #1 and # 2).
3. Remove the orifice from the holder (Figure # 2 ) and replace it with the proper sized one for your gas requirement. Propane requires the smaller orifice.
4. If you are converting to propane (LP) gas, slide the air shutter so that the air intake hole is open (Figure #1). For natural gas, slide the air shutter so that the air intake hole is closed (Figure #2).
5. **IT IS NECESSARY TO ATTACH THE LABEL OR RATING PLATE INCLUDED WITH THE CONVERSION KIT TO CLEARLY INDICATE THE FIELD CONVERSION.**

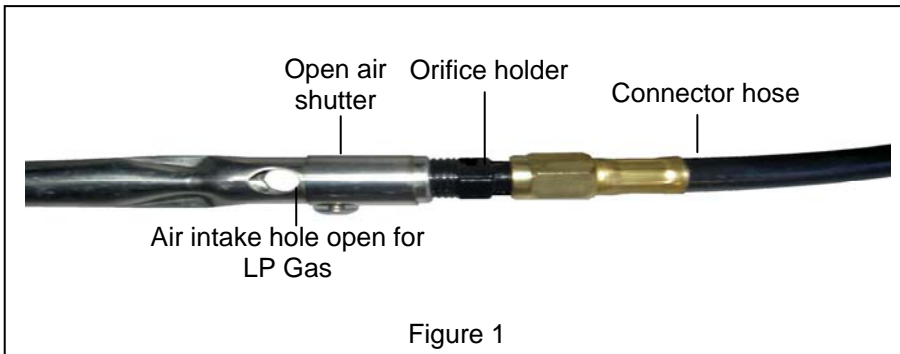

Figure 1

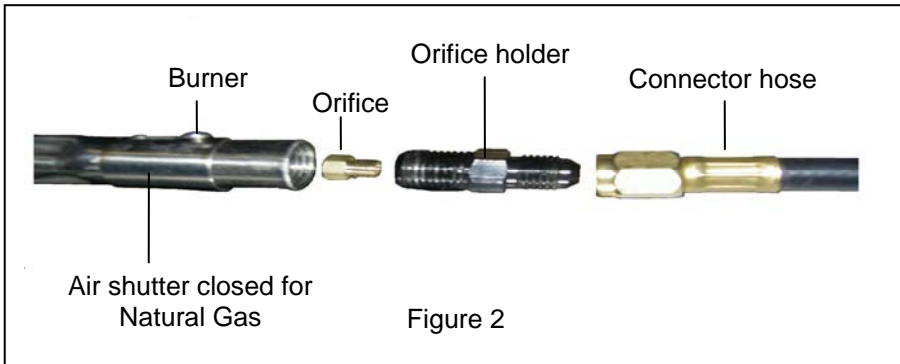

Figure 2

For installations above 2,000 feet, contact your local dealer or gas supplier before installing as input ratings will be reduced approximately 4% for each 1,000 feet above sea level. Refer to the National Fuel Gas Code.

**\*High Altitude Conversion Kit**  
Contact your distributor to obtain a High Altitude Conversion Kit. Conversion kit includes the proper orifice, conversion diagram and conversion label.

Follow steps 1 – 5 shown above.

THE CONVERSION SHALL BE  
CARRIED OUT BY A  
MANUFACTURER'S AUTHORIZED  
REPRESENTATIVE, IN ACCORDANCE  
WITH THE REQUIREMENTS OF THE  
MANUFACTURER, PROVINCIAL OR  
TERRITORIAL AUTHORITIES HAVING  
JURISDICTION AND IN ACCORDANCE  
WITH THE REQUIREMENTS OF THE  
CAN/CGA-B149.1 OR CAN/CGA-B149.2  
INSTALLATION CODES.

After conversion follow Operating  
Instructions found on Page 7.

## MANUFACTURER'S USE ONLY

Quality Check

Date: \_\_\_\_\_

Orifice # (MAIN) \_\_\_\_\_  
 Orifice # (OTHER) \_\_\_\_\_  
 Leak Test: \_\_\_\_\_  
 Burn Test: \_\_\_\_\_  
 Gas Type:           NAT / LP          

Model # \_\_\_\_\_  
 Serial # \_\_\_\_\_  
 Air Shutter: \_\_\_\_\_  
 Inspector: \_\_\_\_\_