

ISOFLAMES® Linear Burner

Installation, Operation, Maintenance and Owner's Manual

Isoflames Linear Burner Models:

ISF24LB - ISF36LB – ISF48LB

ISF60LB - ISF72LB - ISF96LB

A PRODUCT OF EARTHCORE® INDUSTRIES, LLC

Important: This manual contains assembly rules, installation steps, guidelines, use and maintenance instructions for the Isoflames Linear Burner Series. This manual must become the property of and be reviewed by all current and future users of this product. It is the responsibility of the general contractor and the installer of this product to ensure that the instructions in this manual are followed exactly and be installed in strict accordance with the following sizing, installation, and operation instructions. It is the responsibility of the general contractor to provide adequate clearances from all firebox surfaces as specified in this manual.

INSTALLER: Leave this manual with the appliance
CONSUMER: Retain this manual for future reference

Be Sure to Read Entire Manual Before Beginning Construction.

Contents of this manual may change without prior notification.



WARNING:

FIRE OR EXPLOSION HAZARD

Failure to follow safety warning exactly could result in serious injury, death, or property damage.

- **Do not store or use gasoline or other flammable vapors and liquids in the vicinity of this or any other appliance.**
- **WHAT TO DO IF YOU SMELL GAS**
 - **Do not try to light any appliance.**
 - **Leave the building immediately.**
 - **Do not touch any electrical switch; do not use any phone in your building.**
 - **Immediately call your gas supplier from a neighbor's phone. Follow the gas supplier's instructions.**
 - **If you cannot reach your gas supplier, call the fire department.**
- **Installation and service must be performed by a qualified installer, service agency or the gas supplier.**

Design Certified to Z21.60 - Decorative Gas Appliance for installation in solid-fuel burning fireplace

The Isoflames Linear Burner is to be installed in solid-fuel burning fireplace with a working flue and constructed of noncombustible material. The installation including provisions for combustion and ventilation air must conform with the National Fuel Gas Code, ANSI Z223.1/NFPA 54, or the CSA B149.1 Natural Gas and Propane Installation Code, and applicable local building codes. chimney damper must be fixed in a manner that will maintain the minimum permanent vent opening at all times. A damper clamp is supplied to maintain the minimum permanent vent opening and prevent complete closure of damper flap. Warning: Solid fuels shall not be burned in a fireplace where a decorative appliance is installed.

PFS Report No. F19-161



Issued: October 2025

Revision: 001.2

©2025 Earthcore Industries, LLC

THESE APPLIANCES ARE DESIGNED FOR USE WITH:

PROPANE (LP) OR NATURAL GAS (NG), ONLY

THIS MANUAL CAN ONLY BE REPRODUCED IN ITS ENTIRETY

Table of Contents

Table of Contents..... 2

Isoflames Linear Burner - Safety Instructions 4

Isoflames Linear Burner - Components List 6

Isoflames Linear Burner - Specifications 7

Gas Line & Valve Box Installation..... 8

Valve Box & Burner Wiring Diagram 9

Burner Installation 10

Burner Assembly Connection..... 12

Remote Control System 16

Burner Lighting Instructions..... 18

Troubleshooting..... 19

Glass Media Options 20

Optional Log Sets 21

Registration Card 23

Warranty..... 24

The latest revision of this manual may be
obtained at the Earthcore website:

<https://www.earthcore.com/installation-manuals/>

OR

Scan this QR code

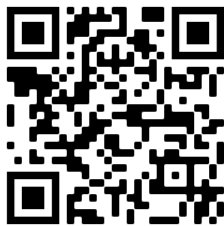

Isoflames Linear Burner - Safety Instructions

WARNING!!! This appliance assembly contains burner orifices specifically for the input gas specified on the burner and box, as well as the BTU rating specified in this manual. Modifying or failure to use the factory orifice may cause property damage, personal injury, or loss of life.

Read these instructions completely before installing and using ISOFLAMES Linear Burner.

- 1)** Solid fuels shall not be burned in any fireplace where a decorative appliance has been installed.
- 2)** The minimum inlet supply pressure for the purpose of input adjustment is 5.0 inches (natural gas) 11.0 inches (propane) in water column. The maximum inlet supply pressure is 10.5 inches (natural gas) 13.0 inches (propane) in water column.
- 3)** Gas type will be indicated on the burner rating plate. Do not use a natural gas burner with propane or a propane burner with natural gas. Appliance is not convertible to use other gases.
- 4)** The installation, provisions for combustion, and ventilation air must conform to the National Fuel Gas Code, ANSI Z223.1/ NFPA 54, or the Natural Gas and Propane Installation code, CSA B149.1.
- 5)** The appliance and its main gas valve must be disconnected from the gas supply piping system during any pressure testing of that system at test pressures in excess of 1/2 psi (3.5 kPa). The appliance must be isolated from the gas piping system by closing its equipment shutoff valve during any pressure testing of the supply piping system at test pressures equal to or less than 1/2 psi (3.5 kPa).
- 6)** Do not use this appliance if any part has been under water. Immediately call a qualified service technician to inspect the appliance and to replace any part of the control system and any gas control which has been under water.
- 7)** Periodic examination and cleaning of the venting system of the solid fuel burning fireplace, including frequency of such examination and cleaning, by a qualified agency.
- 8)** The appliance area is to be clear and free from combustible materials, gasoline and or flammable vapors and liquids. For warranty to be valid gas log sets must be installed by a NFI certified or other qualified professional installer.
- 9)** Always check local building codes governing fireplaces and fireplace installations. ISOFLAMES Linear Burner installation must comply with all local, regional, state, and national codes and regulations.
- 10)** This appliance is only for use with the type of gas indicated on the rating plate. This appliance SHALL NOT be field converted for use with other gases with Propane (LP) or Natural Gas (NG).
- 11)** This appliance shall only be installed, serviced, or inspected by qualified professional service technician.
- 12)** For propane (LP) use do not place propane supply tank(s) inside any structure. Locate propane supply tank(s) outdoors.
- 13)** To prevent performance problems, do not use propane fuel tank of less than 100 lbs. capacity.
- 14)** This decorative gas appliance reaches high temperature. Keep children and adults away from hot surfaces to avoid burns or clothing ignition. Fireplace will remain hot for a time after shutdown. Allow surfaces to cool before touching.
- 15)** Turn the appliance off and allow to cool before servicing. Always shut off any electricity and gas to the appliance while working on it. Only a qualified service person should install, service or repair this appliance. Have your appliance inspected annually by a qualified service person.

Isoflames Linear Burner - Safety Instructions

- 16)** It is imperative that the unit's control areas, burners and circulation air passages be kept clean.
- 17)** Keep all combustible material, gasoline, and other flammable liquids at a safe distance from the fireplace. Do not use the appliance where these items are used or stored. Decorations, clothing, and other such combustible items should not be placed on the appliance.
- 18)** Do not cook food or burn paper or other object(s).
- 19)** Do not use any solid fuels - wood, coal, paper, cardboard, etc. - Use only the gas type listed on the fireplace's burner rating plate.
- 20)** Do not in any way obstruct the flow of combustion and ventilation air. Provide adequate clearances around air openings into the combustion chamber as well as adequate accessibility clearances for servicing and proper operation.
- 21)** Never install an ISOFLAMES Linear Burner component or accessory that has visible or suspected physical damage. These items should be inspected by a qualified representative to ensure safe condition. When in doubt, consult your local supplier.
- 22)** Do not alter or modify the ISOFLAMES Linear Burner or burner components under any circumstances. Modification or alteration of any sort may void manufacturer's warranty, listings, and approvals.
- 23)** The ISOFLAMES Linear Burner system is not intended to heat an entire home or to be used as a primary heat source.
- 24)** Children and adults should be alerted to the hazards of high surface temperature and should stay away from this appliance to avoid burns or clothing ignition.
- 25)** Young children should be carefully supervised when they are in the same room as the appliance. Toddlers, young children, and others may be susceptible to accidental contact burns. A physical barrier is recommended if there are at-risk individuals in the house. To restrict access to the fireplace, install an adjustable safety gate to keep toddlers, young children and other at-risk individuals out of the room and away from hot surfaces.
- 26)** Clothing or flammable material should not be placed on or near the appliance.
- 27)** Due to high temperatures, the appliance should be located out of traffic and away from furniture and draperies.
- 28)** Any safety screen, guard, or barrier removed for servicing an appliance must be replaced prior to operating the appliance.
- 29)** Installation and repair should be done by a qualified service person. The appliance should be inspected before use and at least annually by a professional service person. More frequent cleaning may be required due to excessive lint from carpeting, bedding material, etcetera. It is imperative that control compartments, burners, and circulating air passageways of the appliance be kept clean.

Isoflames Linear Burner - Safety Instructions

WARNING!!!: This product contains or generates chemicals known to the state of California to cause cancer or birth defects or other reproductive harm.

IMPORTANT: Read this owner's manual carefully and completely before trying to assemble, operate or service this fireplace. Improper use of this fireplace can cause serious injury or death from fire, burns, explosions and carbon monoxide poisoning.

DANGER!!!: CARBON MONOXIDE POISONING MAY LEAD TO DEATH!

Propane (LP) gas and natural gas (NG) are both colorless and odorless gases. An odor making agent is added to each of these gases to help you detect a gas leak. However, the odor added to these gases can fade and gas may be present even though no odor exists.

Carbon Monoxide Poisoning: Early signs of carbon monoxide poisoning resemble flu symptoms, including headaches, dizziness or nausea. If you have these signs the fireplace may not have been installed properly, get fresh air at once! Have the fireplace inspected and serviced by a qualified service person or your gas supplier. Some people are more affected by carbon monoxide than others. These include pregnant women, people with heart or lung diseases or anemia, people at high altitude or under the influence of alcohol. Earthcore Industries strongly recommends the use of a carbon monoxide detector/alarm device wherever gas fired appliances are in use.

All parties either involved in or associated with the installation, service and use of this fireplace must read this entire manual. Keep this manual for reference and as a guidebook to safe operation of this fireplace.

WARNING!!!: This unit is not for use with solid fuel.

Isoflames Linear Burner - Rating Plate

Natural Gas Label



MADE IN THE USA
CHESAPEAKE, VA 23323

ISOFLAMES LINEAR BURNER

NOT FOR USE WITH SOLID FUEL

SERIAL NO: LBN000001



US
PFS REPORT NO. F19 - 161

GAS TYPE: NATURAL GAS
MANIFOLD PRESSURE: 3.5" - 1.6" WC
MINIMUM INLET GAS SUPPLY PRESSURE: 5" WC
MAXIMUM INLET GAS SUPPLY PRESSURE: 10.5 WC

ANSI Z21.60-2017 • CSA 2.26-2017,
Decorative Gas Appliances for Installation in
Solid-Fuel Burning Fireplaces

MODEL #

| | |
|---|---|
| <input type="checkbox"/> ISF24LBN MAX BTU 36,000; MIN BTU 25,000 | WARNING: For installation in a solid-fuel burning fireplace only. The fireplace chimney must have a permanent vent opening to atmosphere of not less than (see table) square inches and a minimum chimney height of 15' |
| <input type="checkbox"/> ISF36LBN MAX BTU 54,000; MIN BTU 38,000 | |
| <input type="checkbox"/> ISF48LBN MAX BTU 72,000; MIN BTU 50,000 | |
| <input type="checkbox"/> ISF60LBN MAX BTU 90,000; MIN BTU 63,000 | |
| <input type="checkbox"/> ISF72LBN MAX BTU 108,000; MIN BTU 75,000 | |
| <input type="checkbox"/> ISF96LBN MAX BTU 110,000; MIN BTU 84,000 | |

| MINIMUM FIREPLACE DIMENSION (in): | | | | | | CHIMNEY OPENING (in ²) |
|-----------------------------------|-------|--------|------------|-------------|----|------------------------------------|
| MODEL | DEPTH | HEIGHT | REAR WIDTH | FRONT WIDTH | | |
| 24 | 17.5 | 16 | 25 | 36 | 24 | |
| 36 | 17.5 | 16 | 37 | 48 | 35 | |
| 48 | 17.5 | 16 | 49 | 60 | 45 | |
| 60 | 17.5 | 16 | 61 | 72 | 55 | |
| 72 | 17.5 | 16 | 73 | 84 | 65 | |
| 96 | 17.5 | 16 | 97 | 108 | 65 | |

EARTHCORE INDUSTRIES HEADQUARTERS
6899 PHILLIPS INDUSTRIAL BLVD
JACKSONVILLE, FL 32256

L.P.G (propane) Label



MADE IN THE USA
CHESAPEAKE, VA 23323

ISOFLAMES LINEAR BURNER

NOT FOR USE WITH SOLID FUEL

SERIAL NO: LBP000001



US
PFS REPORT NO. F19 - 161

GAS TYPE: Propane (LPG)
MANIFOLD PRESSURE: 10" - 6.4" WC
MINIMUM INLET GAS SUPPLY PRESSURE: 11" WC
MAXIMUM INLET GAS SUPPLY PRESSURE: 14" WC

ANSI Z21.60-2017 • CSA 2.26-2017
Decorative Gas Appliances for Installation in
Solid-Fuel Burning Fireplaces

MODEL #

| | |
|---|---|
| <input type="checkbox"/> ISF24LBP MAX BTU 32,000; MIN BTU 24,000 | WARNING: For installation in a solid-fuel burning fireplace only. The fireplace chimney must have a permanent vent opening to atmosphere of not less than (see table) square inches and a minimum chimney height of 15' |
| <input type="checkbox"/> ISF36LBP MAX BTU 48,000; MIN BTU 36,000 | |
| <input type="checkbox"/> ISF48LBP MAX BTU 64,000; MIN BTU 48,000 | |
| <input type="checkbox"/> ISF60LBP MAX BTU 80,000; MIN BTU 60,000 | |
| <input type="checkbox"/> ISF72LBP MAX BTU 96,000; MIN BTU 72,000 | |
| <input type="checkbox"/> ISF96LBP MAX BTU 105,000; MIN BTU 84,000 | |

| MINIMUM FIREPLACE DIMENSION (in): | | | | | | CHIMNEY OPENING (in ²) |
|-----------------------------------|-------|--------|------------|-------------|----|------------------------------------|
| MODEL | DEPTH | HEIGHT | REAR WIDTH | FRONT WIDTH | | |
| 24 | 17.5 | 16 | 25 | 36 | 22 | |
| 36 | 17.5 | 16 | 37 | 48 | 31 | |
| 48 | 17.5 | 16 | 49 | 60 | 40 | |
| 60 | 17.5 | 16 | 61 | 72 | 49 | |
| 72 | 17.5 | 16 | 73 | 84 | 57 | |
| 96 | 17.5 | 16 | 97 | 108 | 62 | |

EARTHCORE INDUSTRIES HEADQUARTERS
6899 PHILLIPS INDUSTRIAL BLVD
JACKSONVILLE, FL 32256

Isoflames Linear Burner - Components List

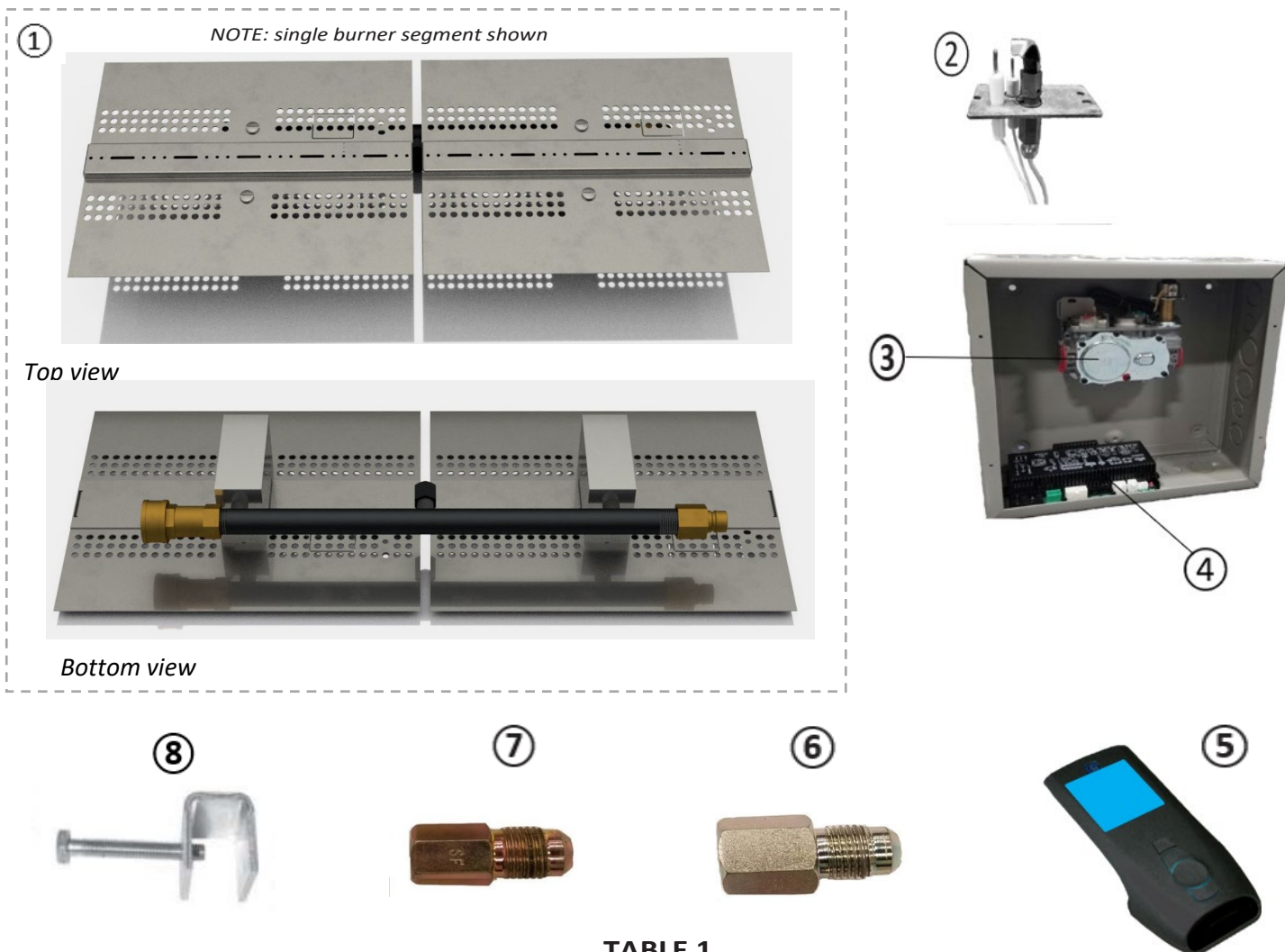

TABLE 1

| Item No. | Description | Part No. | Qty |
|----------|------------------------------------|--------------------------|-----|
| 1 | Main Burner Assembly (natural gas) | ISF-E-24/36/48/60/72/96N | 1 |
| | Main Burner Assembly (propane) | ISF-E-24/36/48/60/72/96P | 1 |
| 2 | Pilot Assembly (natural gas) | ISF-E-PAN | 1 |
| | Pilot Assembly (propane) | ISF-E-PAP | 1 |
| 3 | Gas Valve (natural gas) | ISF-E-GVN | 1 |
| | Gas Valve (propane) | ISF-E-GVP | 1 |
| 4 | Control module/remote receiver | ISF-E-ICM | 1 |
| 5 | Remote Transmitter | ISF-E-RMT | 1 |
| 6 | 1/2" Flared fitting female adapter | E-12FF-12FIP | 1 |
| 7 | 3/8" Flared fitting female adapter | E-12FF-38FIP | 1 |
| 8 | Damper Clamp | ISF-E-DC | 1 |

Isoflames Linear Burner - Specifications

TABLE 2

| Burner Specifications | | | | | | | | |
|-----------------------|----------------------------------|--------|-------|------|----------|-----|----------|-----|
| Burner Model | Minimum Fireplace Dimension (in) | | | | BTU | | | |
| | Depth | Height | Width | | Nat. Gas | | L.P. Gas | |
| | | | Front | Rear | High | Low | High | Low |
| ISF24LB | 17.5 | 16 | 36 | 25 | 36K | 25K | 32K | 24K |
| ISF36LB | 17.5 | 16 | 48 | 37 | 54K | 38K | 48K | 36K |
| ISF48LB | 17.5 | 16 | 60 | 49 | 72K | 50K | 64K | 48K |
| ISF60LB | 17.5 | 16 | 72 | 61 | 90K | 63K | 80K | 60K |
| ISF72LB | 17.5 | 16 | 84 | 73 | 108K | 75K | 96K | 72K |
| ISF96LB | 17.5 | 16 | 108 | 97 | 108K | 84K | 105K | 87K |

NOTE: Opening height is measured from hearth floor to bottom of lintel

TABLE 3

| Minimum Venting Requirements | | | | | | |
|------------------------------|---|---------|---------|---------|---------|---------|
| Chimney height (ft) | Minimum Permanent Free Opening of Chimney Damper (sq. in) | | | | | |
| | Factory-Built Fireplace | | | | | |
| | ISF24LB | ISF36LB | ISF48LB | ISF60LB | ISF72LB | ISF96LB |
| 15 | 16 | 24 | 33 | 46 | - | - |
| 20 | 13 | 21 | 27 | 38 | - | - |
| 25 | 12 | 17 | 24 | 32 | 43 | 43 |
| 30 | 10 | 16 | 22 | 29 | 38 | 38 |
| | Masonry-Built Fireplace | | | | | |
| | 15 | 23 | 35 | 44 | 54 | 65 |
| | 20 | 22 | 32 | 41 | 49 | 59 |
| 30 | 20 | 29 | 38 | 45 | 53 | 53 |

Note: Height is measured from hearth to top of chimney and minimum height is 15 ft.

Gas Line & Valve Box Installation

This appliance must be connected to the gas line in accordance with local codes and/or the National Fuel Gas Code, ANSI Z223.1. After connecting the gas line, all joints in the line and connections at the valve should be checked for leaks before final positioning of the unit. Conduct a gas leakage test of the appliance piping and control system downstream of the shutoff valve in the supply line to the appliance.

- 1) The valve control box comes with an 110" pilot assembly lead; therefore, the box must be mounted within 7' of the fireplace for models ISF24/36/48/60LB and within 2' for models ISF72/96LB. **(Figure 1)**
- 2) Attach the metal enclosure to the studs using standard building materials. The metal enclosure must be mounted in a location that can be accessed in the future for additional connections & future servicing.
- 3) Installation and servicing of gas appliances and ignition systems must only be performed by qualified personnel.
- 4) Turn off gas and electricity before starting installation or service.
- 5) Make sure gas piping is pressure tested before control is connected. High pressure can damage the control causing a hazardous condition.
- 6) Make sure piping is clean and free from burrs. Apply a small amount of good quality gas-rated pipe thread compound or plumbers' tape suitable for the gas being used. Thread compound should be used sparingly on male threads only, leaving the first two threads clean.
- 7) It is recommended that a safety shut off valve is installed on either the gas in or gas outside of the valve.
- 8) It is recommended to hard pipe in the connections with unions installed inside the box.
- 9) Uncoil the pilot assembly. Be careful to not create unwanted kinks in the pilot tubing.
- 10) Feed the spade connector ends of the pilot assembly from inside the fireplace to the outside being careful not to clog the flared fitting of the pilot tube or damage the spade connectors.
- 11) Plug the spade connectors into the module according to the below wiring diagram **(Figures 2 & 3)**, insert the pilot tubing into the right side of the valve and, using a wrench, tighten the nut so that the pilot tubing cannot be pulled out.

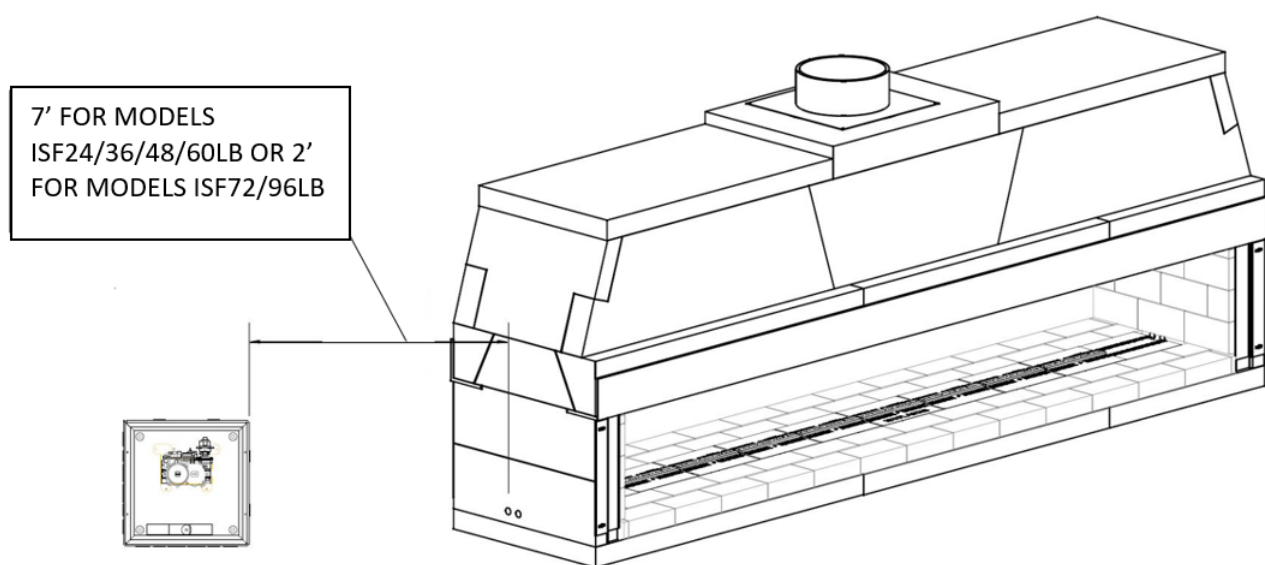

FIGURE 1

Valve Box & Burner Wiring Diagram

WARNING!!!: Do not connect 120 VAC to the control valve.

The appliance and its appliance main gas valve must be disconnected from the gas supply piping system during any pressure testing of that system at test pressures in excess of 1/2 psi (3.5 kPa).

The appliance, when installed, must be electrically grounded in accordance with local codes or in the absence of local codes, with the National Electrical Code, ANSI/NFPA 70. If not installed and maintained in accordance with the manufacturer’s instructions, this product could expose you to substances in fuel or fuel combustion which are known to the state of California to cause cancer, birth defects or other reproductive harm.

For a copy of the homeowner’s care and operation manual, go to www.earthcore.com or call 1-800-642-2920.

FIGURE 2

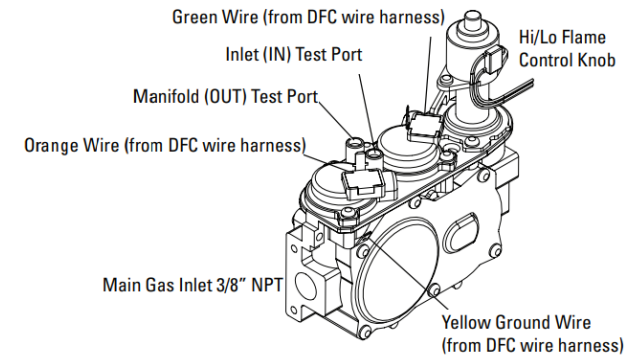
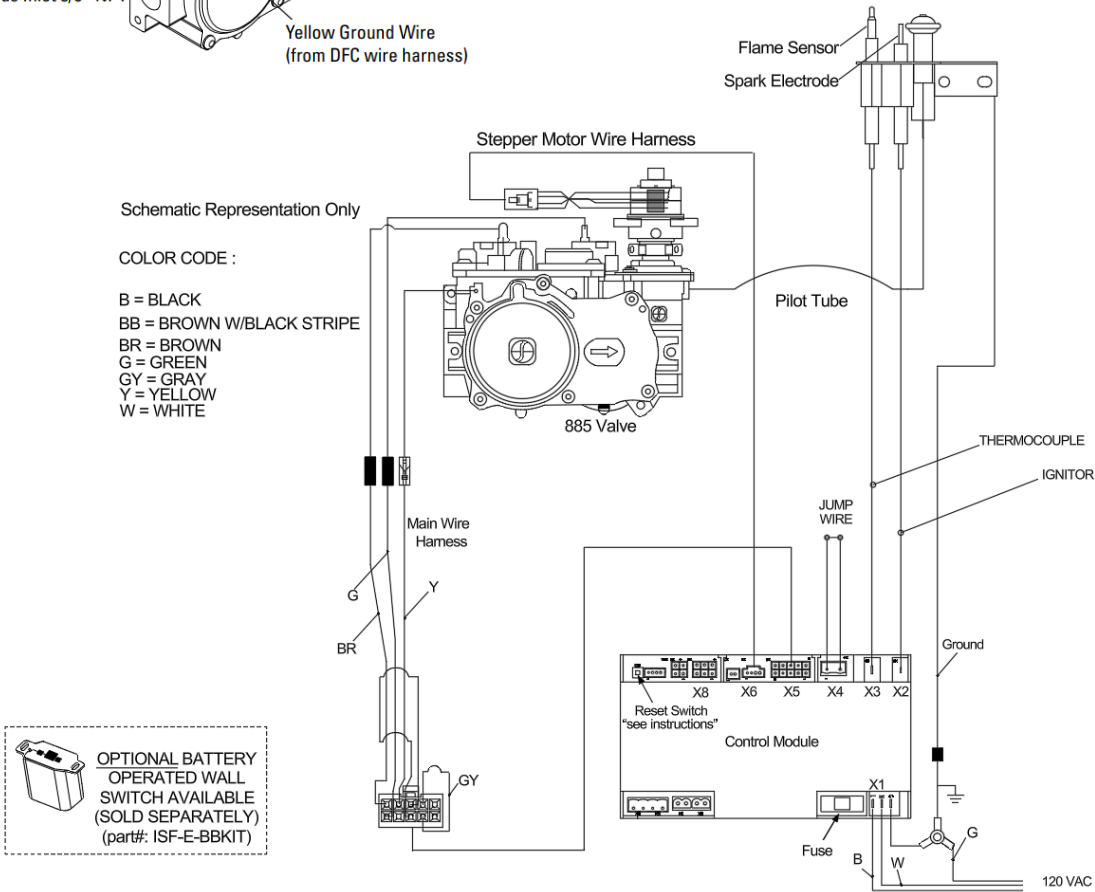

TABLE 4

| Fuel Type | Inlet Pressure | | | Manifold Pressure | |
|-------------|----------------|----------|----------|-------------------|------------|
| | Desired | Minimum | Maximum | On Hi Fire | On Lo Fire |
| Natural Gas | 7" WC | 5" WC | 10.5" WC | 3.5" WC | 1.6" WC |
| LP Gas | 11" WC | 10.5" WC | 13" WC | 10" WC | 6.4" WC |



NOTE: FOR MAXMUS LINEAR FIREPLACE APPLICATIONS OF THE ISOFLAMES LINEAR BURNER; REFERENCE THE WIRING SCHEMATIC IN THE MAXIMUS LINEAR SERIES FIREPLACE INSTALLATION MANUAL

FIGURE 3

Burner Installation

IMPORTANT: Prior to installation: Shut off main gas supply to fireplace.

- The ISOFLAMES Linear Burner system shall be installed by qualified professional service technician. To ensure proper performance of the appliance the owner's installation manual must be followed carefully.
- The ISOFLAMES Linear Burner is designed to be recessed into the 2 1/2" deep firebrick cavity constructed as detailed in **Table 5**
- The burner cavity must have a height of 2-1/2", a depth of 9-1/4", and the length shall extend the entire width of firebox.
- If the gas supply pipe, from the external mounted valve, is brought into the cavity through the sidewall of the firebox, the cavity must extend to the firebox sidewall
- For models ISF24/36/48/60LB: Gas supply shall terminate not less than 3" from sidewall. **Figure 6**
- For models ISF72/96LB: Gas supply shall terminate within than 3" from center of the cavity. **Figure 6**

TABLE 5

| BURNER CAVITY DIMENSIONS (in) | | | |
|-------------------------------|--------|-------|--------------|
| Burner Model | Height | Width | Length (Min) |
| ISF24LB | 2-1/2 | 9-1/4 | 23 |
| ISF36LB | 2-1/2 | 9-1/4 | 35 |
| ISF48LB | 2-1/2 | 9-1/4 | 47 |
| ISF60LB | 2-1/2 | 9-1/4 | 59 |
| ISF72LB | 2-1/2 | 9-1/4 | 71 |
| ISF96LB | 2-1/2 | 9-1/4 | 95 |

Note: make sure cavity length has enough space for gas supply line.

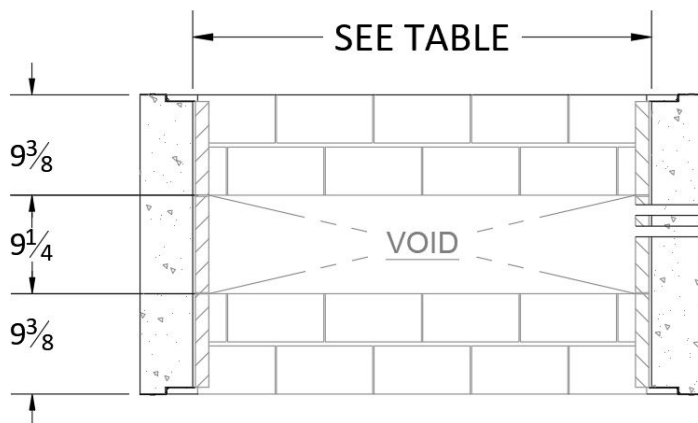

FIGURE 4

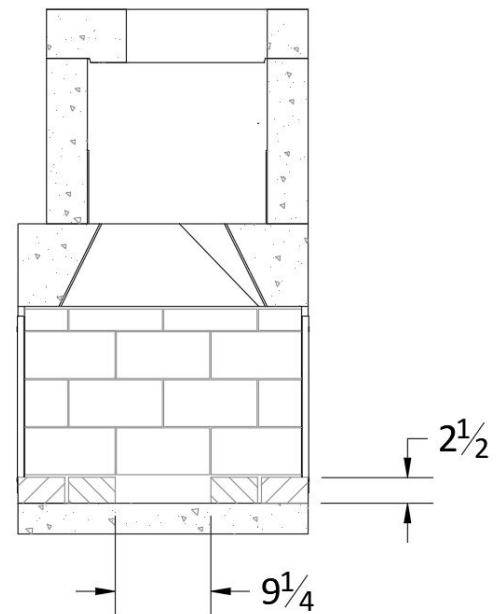

FIGURE 5

Burner Installation

1. Connect all burner segments according to burner model diagram Page 11 - 15. Make sure all connections are tightly secured.
2. Place burner assembly in center of fireplace floor/cavity.
3. Rotate the burner to position the gas inlet flared fitting to be on same side as the gas-supply stub coming from the gas valve.
(Not necessary for models ISF72/96LB)
4. Remove the burner top pan closest to the gas-supply stub. Remove the top pan by unscrewing the two screws. This will allow easier access and connection of flex connector to the flared fitting. This will also be used for pilot assembly installation.
5. Ensure the appropriate 3/8" flared fitting is connected to the gas supply stub.
6. Connect the 12" flex connector to the gas inlet flared fitting on the burner assembly.
7. Connect the other end of 12" flex connector to the gas-supply.
8. Avoid creating kinks in the flex connector.
9. Make sure all connections are tightly secured.
10. Before replacing the removed burner top from **step 4**, locate the perforated rectangular section in the pan. Gently remove this section along the perforations using a screwdriver or pliers. **Figure 7**
11. Insert the pilot assembly from underneath the existing burner pan to the area of the removed burner section. **Figure 8**
12. Mount the pilot assembly to the removed burner pan using the screws provided with the pilot assembly. Be careful not to kink the pilot assembly tube as it can severely damage the pilot tube. **Figure 9**
13. Place the removed burner top back on to the orifice block and secure tightly with the pan head screws.
14. Check appliance operation. See Burner lighting instructions Page 16.
15. Spread glass media evenly across burner. Do not fill cavity with glass media.
16. Make sure glass media does not obstruct pilot assembly.
17. Optional gas logs available, shown on page 20.

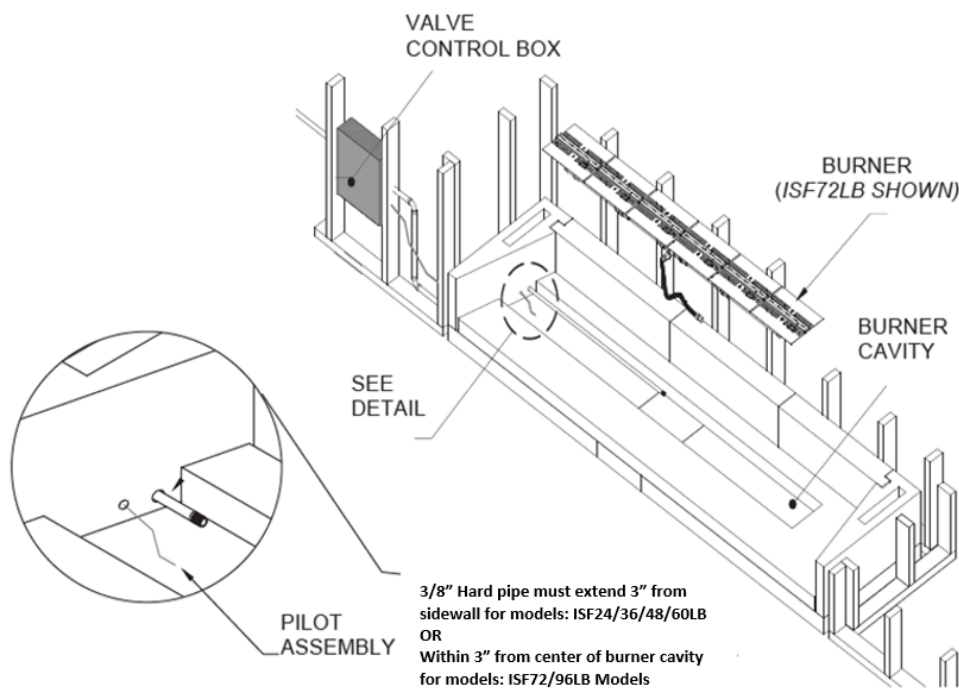

FIGURE 6

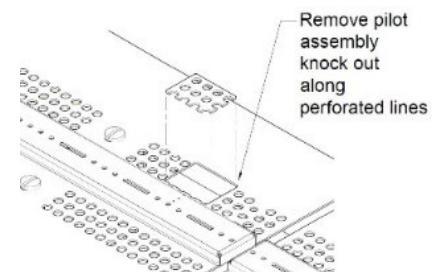

FIGURE 7

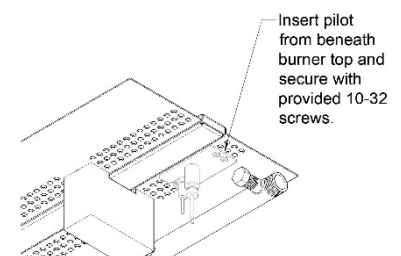

FIGURE 8

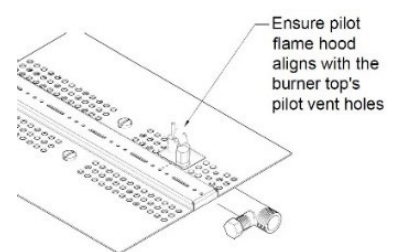
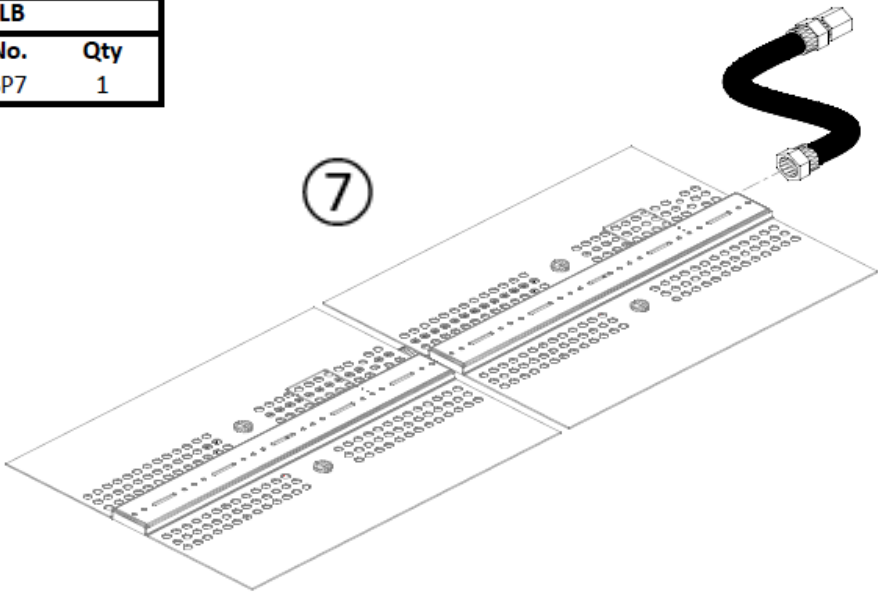

FIGURE 9

Burner Assembly Connection

24” Burner Connection - ISF36LB

| ISF24LB | | |
|---------|----------|-----|
| Box No. | Part No. | Qty |
| 7 | E-18BP7 | 1 |



36” Burner Connection - ISF36LB

| ISF36LB | | |
|---------|----------|------|
| Box No. | Part No. | Qty. |
| 4 | E-18BP4 | 1 |
| 8 | E-12BP1 | 1 |

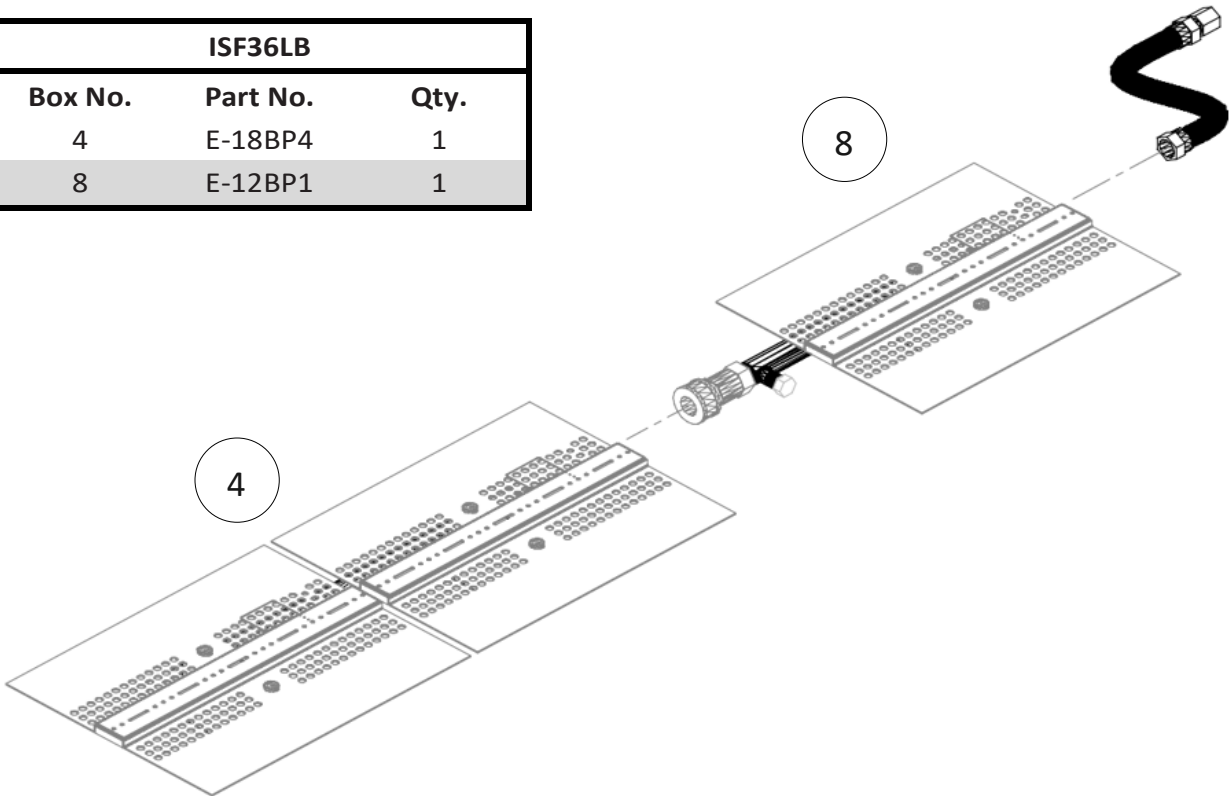

48” Burner Connection – ISF48LB

| ISF48LB | | |
|---------|----------|-----|
| Box No. | Part No. | Qty |
| 2 | E-18BP2 | 1 |
| 8 | E-12BP1 | 1 |
| 11 | E-12BP4 | 1 |

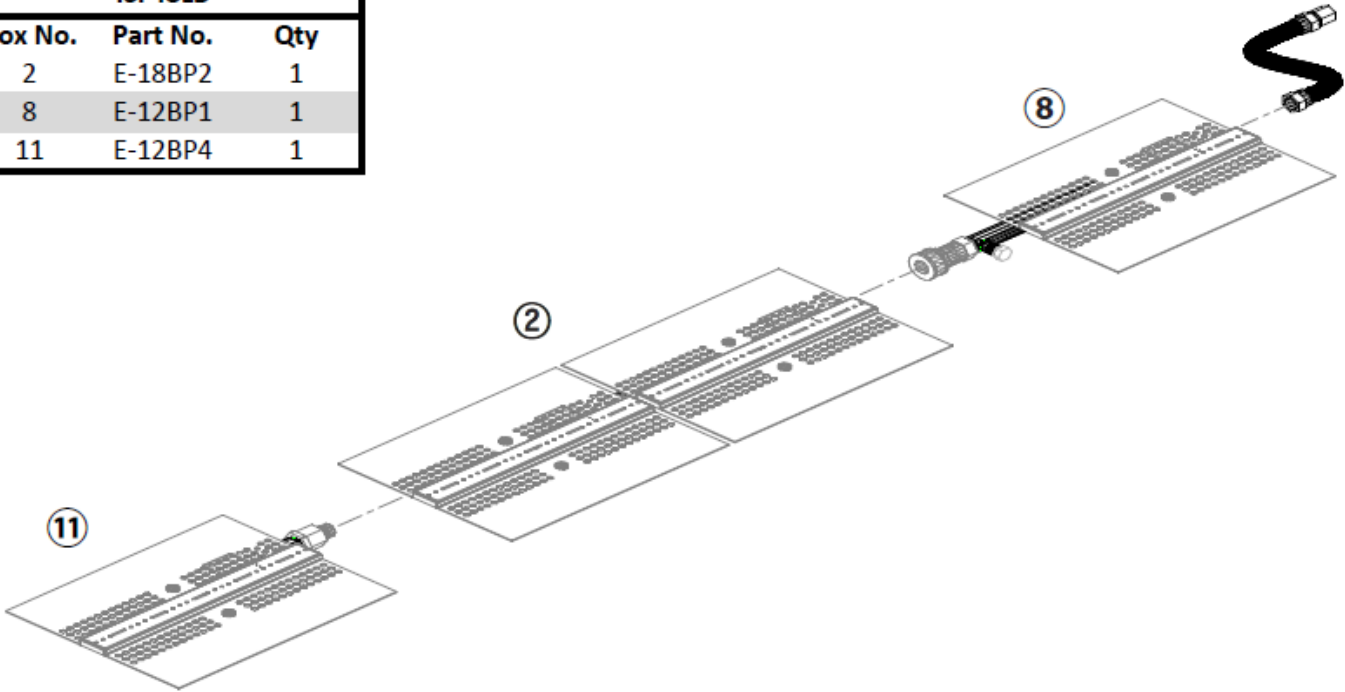

60” Burner Connection – ISF60LB

| ISF60LB | | |
|---------|----------|------|
| Box No. | Part No. | Qty. |
| 1 | E-18BP1 | 1 |
| 4 | E-18BP4 | 1 |
| 6 | E-18BP6 | 1 |

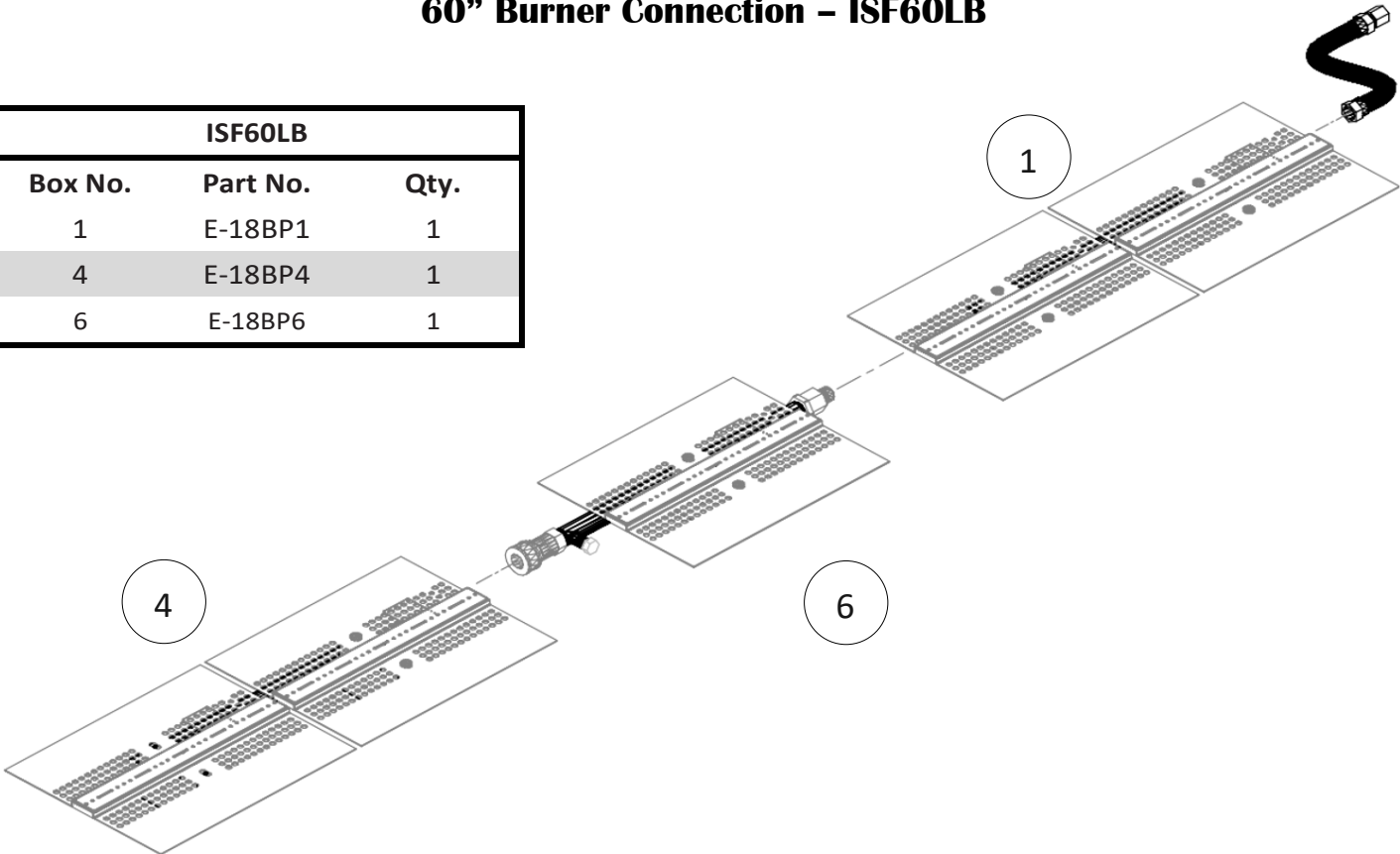

72” Burner Connection – ISF72LB

| ISF72LB | | |
|---------|----------|------|
| Box No. | Part No. | Qty. |
| 4 | E-18BP4 | 1 |
| 5 | E-18BP5 | 1 |
| 9 | E-12BP2 | 1 |
| 10 | E-12BP3 | 1 |
| 13 | E-BPC | 1 |

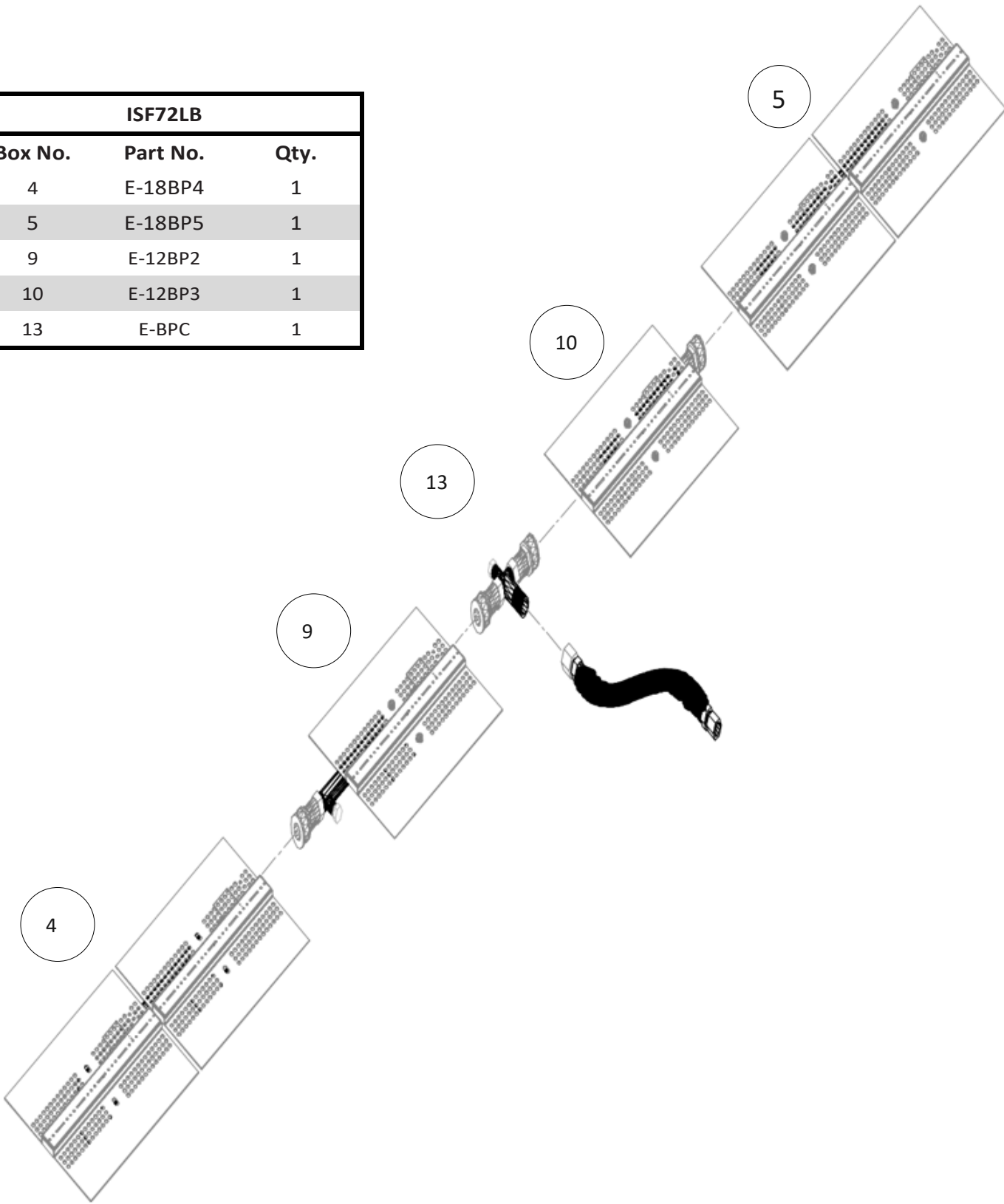

96” Burner Connection – ISF96LB

| ISF96LB | | |
|---------|----------|------|
| Box No. | Part No. | Qty. |
| 2 | E-18BP2 | 1 |
| 3 | E-18BP3 | 1 |
| 9 | E-12BP2 | 1 |
| 10 | E-12BP3 | 1 |
| 11 | E-12BP4 | 1 |
| 12 | E-12BP5 | 1 |
| 13 | E-BPC | 1 |

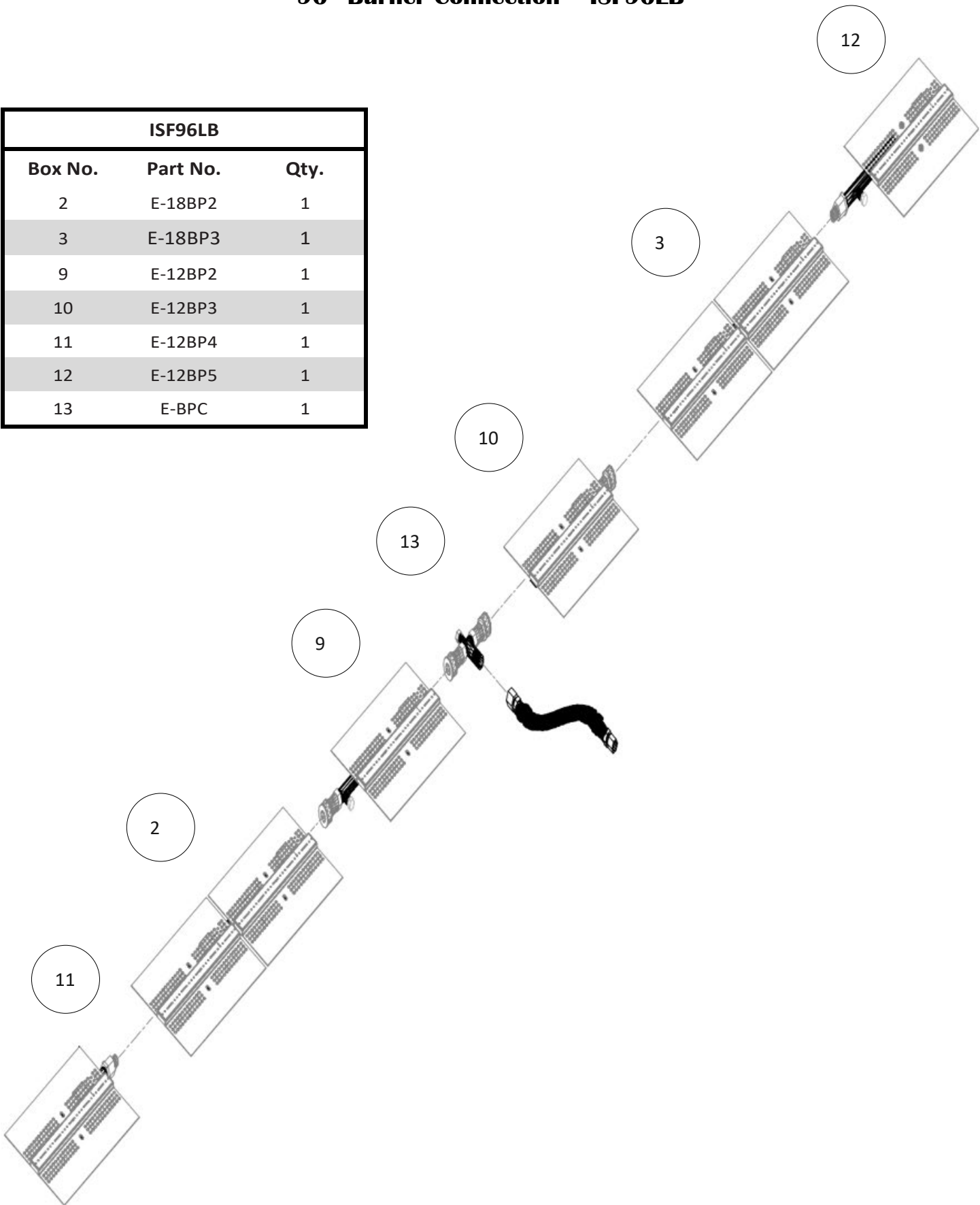

Remote Control System

The Remote allows you to command the functions of your appliance from the comfort of your chair and is configured to control the On/Off primary burner operation, its flame height through six (6) levels, and provides On/Off control of the appliance.

SYNCHRONIZE REMOTE TO CONTROL MODULE FOR THE FIRST TIME

- 1) Insert the three (3) provided AAA batteries into the battery bay in the remote. Correctly align polarity (+/-).
- 2) Press the red SW1 button on the control module. The control module will beep 3 times and an amber LED is illuminated to indicate that the control module is ready to synchronize with a remote within 10 seconds.
- 3) Push the “ON” button on the remote (**Figure 10**). The control module will beep four (4) times to indicate acceptance of the remote’s command. The system is now synchronized.

TURN ON THE APPLIANCE

Press the ON/OFF Key on the Remote. The Remote display will show all active Icons on the screen and the appliance main burner will turn on (**Figure 10**). A single “beep” from the Receiver will confirm reception of the command.

FIGURE 10

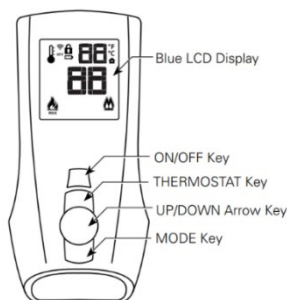

REMOTE FLAME CONTROL

The system has six (6) flame levels. See (**Figure 11**) for an example. With the system on, and the flame level at the maximum in the appliance, pressing the Down Arrow Key once will reduce the flame height by one step until the flame is turned off. The Up-Arrow Key will increase the flame height each time it is pressed. If the Up Arrow Key is pressed while the system is on, but the flame is off, the flame will come on in the high position (**Figure 11**). A single “beep” will confirm reception of the command.

FIGURE 11

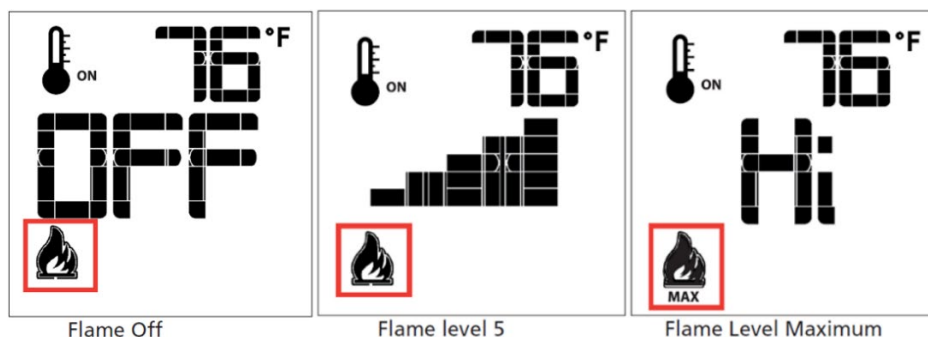

TEMPERATURE INDICATOR DISPLAY

With the system in the “OFF” position, press the Thermostat Key and the Mode Key at the same time (**Figure 10**). Look at the LCD screen on the Remote to verify that a °C or °F is visible to the right of the room temperature display (**Figure 12**).

FIGURE 12

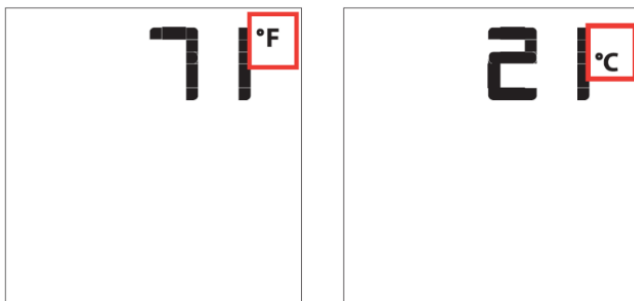

Remote Control System

TURN OFF THE APPLIANCE

Press the ON/OFF Key on the Remote. The Remote LCD display will only show the room temperature and Icon and the appliance burner will turn off. A single “beep” from the Receiver confirms reception of the command.

FLAME COLOR AND BEHAVIOR

This appliance is designed for maximum heating efficiency. Therefore, upon lighting of the main burner, the flames will be semi-transparent or “bluish.” After 10- 20 minutes of operation the logs will heat up and the flames will become a yellow/ orange color.

Adjusting the appliance to cause the flames to turn orange sooner may result in poor combustion, sooting and a hazardous situation. See **(Figure 13)** showing proper flame appearance.

When testing for proper operation, visually determine that main burner gas is burning properly: i.e., no floating, lifting or flashback. Adjust the primary air shutter(s) as required. Check for proper main burner operation at both high and low flame.

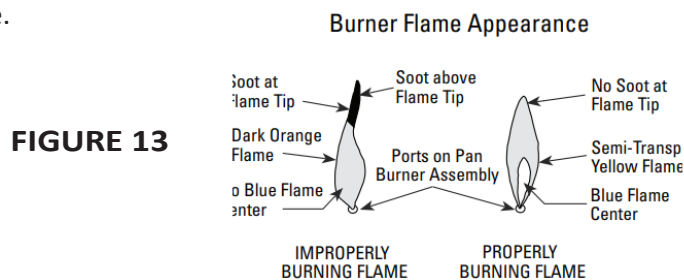

Continuous Pilot (CPI) & Intermittent Pilot (IPI) selection

The IPI selection is the intended setting for the appliance operation. If remote is in CPI mode, it must be returned to the IPI mode. To turn it back the remote needs to be OFF. With the system in the OFF position, press the Mode Key **(Figure 10)** once to index to the CPI mode icon. Pressing the DOWN Arrow Key will return to IPI. A single “beep” will confirm the reception of the command **(Figure 14)**.

FIGURE 14

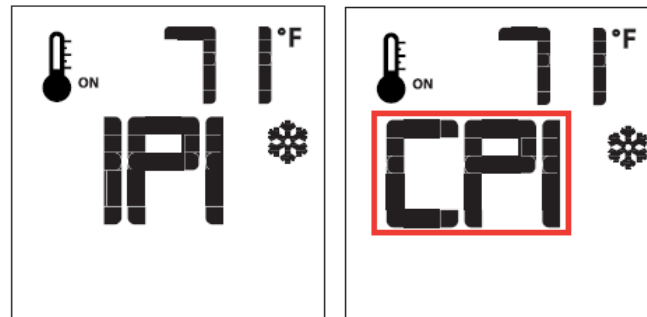

WARNING!!!: Fire hazard. Can cause severe injury or death. The receiver causes ignition of the appliance. The appliance can turn on suddenly. Keep away from the appliance burner when operating the remote system or activating manual bypass of the remote system.

WARNING!!!: Property damage hazard. Excessive heat can cause property damage. The appliance can stay lit for many hours. Turn off the appliance if it is not going to be attended for any length of time. Always place the Transmitter where children cannot reach it

Burner Lighting Instructions

INSTALLER INSTRUCTIONS

It is required that the set of safety instruction labels that have been supplied with the appliance be affixed to the operation and control points of the appliance. It is the installers responsibility to ensure these warnings are properly affixed during installation. These warning labels are a critical step in informing consumers of safe operation of this appliance.

PRE-LIGHTING CHECKLIST

Be sure to check these items before the initial lighting of the appliance:

- Gas pressure has been checked carefully
- All gas fittings have been checked for leaks.
- All clearances to combustibles have been met
- All combustibles materials have been removed from the area in front of the appliance.
- All vented areas of the appliance face are unobstructed.
- House is ventilated to clear initial paint curing odors
- All packaging materials have been removed from the appliance.
- While appliance is cool, fingerprints or other marks have been cleaned from any plated surfaces with denatured alcohol and a soft cloth. Marks left on these surfaces may become permanent into the finish if not removed prior burning the unit.

WARNING!!!: IF YOU DO NOT FOLLOW THESE INSTRUCTIONS EXACTLY, A FIRE OR EXPLOSION MAY RESULT CAUSING PROPERTY DAMAGE, PERSONAL INJURY OR LOSS OF LIFE.

SAFETY INSTRUCTIONS

- A. This appliance is equipped with an ignition device which automatically lights the pilot. Do NOT try to light the pilot by hand.
- B. BEFORE OPERATING smell all around the appliance area for gas. Be sure to smell next to the floor because some gas is heavier than air and will settle on the floor.

WHAT TO DO IF YOU SMELL GAS:

- Do not try to light any appliance.
 - Do not touch any electric switch; do not use any phone in your building.
 - Immediately call your gas supplier from a neighbor's phone. Follow the gas supplier's instructions.
 - If you cannot reach your gas supplier, call the fire department.
- C. If any portion of this appliance does not operate as the instructions indicate, do not try to repair it, call a qualified service technician. Do not use tools. Force or attempted repair may result in a fire or explosion.
 - D. **Do not use this appliance if any part has been under water.** Immediately call a qualified service technician to inspect the appliance and to replace any part of the system and any gas control which has been underwater.

Main Power and Remote Overview

The jumper wire needs to be installed on Terminal X4 on the control module. Once X4 is jumpered, the REMOTE functions as a burner and pilot override switch.

JUMP WIRE



Remote Lighting Instructions

Press ON/OFF on Remote transmitter. Module will beep one time to confirm. Pilot will begin to spark. It may take several minutes for air to purge from pilot tube. Once pilot is ignited, the main burner will turn on

TO TURN OFF GAS TO APPLIANCE

- 1) Press the "ON/OFF" key on remote to turn off appliance operation.
- 2) Turn off all electric power to the appliance if service is to be performed.
- 3) Close the main line gas shut-off valve.





WARNING!!!: OPERATION OF THIS APPLIANCE WHEN NOT CONNECTED TO A PROPERLY INSTALLED AND MAINTAINED VENTING SYSTEM CAN RESULT IN CARBON MONOXIDE (CO) POISONING AND POSSIBLE DEATH.

Troubleshooting

Earthcore Industries Technical Support: 1-800-642-2920

| Issue | Probable Cause | Possible Solution |
|--------------------------------|---------------------------------|--|
| No spark on pilot | No power | - Verify power is ON - Check wiring on ignition module and gas valve are correct |
| | Ignitor misalignment | - Verify ignitor not contacting pilot gas hood |
| | Loose pilot connections | - Check pilot wiring assembly is tightly secured to ignition module |
| Pilot won't ignite | No spark | - See "No spark on pilot" |
| | Air in pilot gas line | - It may take a few minutes to purge out all the air from the pilot gas tube to ignite |
| | No gas | - Verify pilot gas tube is threaded sufficiently to gas valve - Verify all gas connections going to and from gas valve are tight - Verify main gas-shutoff valve is in ON position |
| Pilot won't stay ignited | Flame sensor obstruction | - Remove any obstruction near pilot igniter and flame sensor |
| | Loose pilot connections | - Check pilot wiring assembly is tightly secured to ignition module |
| | Low gas pressure | - Verify adequate gas supply pressure |
| Remote won't work/unresponsive | Range | - Remote is too far from receiver |
| | Batteries need replacement | - Replace batteries on remote transmitter |
| | Program remote to receiver | - Sync remote transmitter to ignition module; Page 16 |
| Main burner won't ignite | Pilot won't ignite | - See "Pilot won't ignite" |
| | Pilot flame won't stay ignited | - See "Pilot won't stay ignited" |
| | Loose burner segments | - Verify burner segments are tight and secure |
| | Orifice blockage | - Remove burner top pan tray and visually inspect orifice gas block |
| | Defective valve/ignition module | - Replace gas valve or ignition module |

Glass Media Options

| Component | Part# | Description |
|---|-----------|--|
|  | RFG-10-PB | 1/2" REFLECTIVE POSEIDON BLUE FIRE GLASS (10 LB JAR) |
|  | RFG-10-TC | 1/2" REFLECTIVE TERRA COPPER FIRE GLASS (10 LB JAR) |
|  | RFG-10-VB | 1/2" REFLECTIVE VESPER BLACK FIRE GLASS (10 LB JAR) |
|  | RFG-10-KD | 1/2" REFLECTIVE KRYSTALLO DIAMOND FIRE GLASS (10 LB JAR) |
|  | RFG-10-AD | 1/2" REFLECTIVE AMBER DIAMOND FIRE GLASS (10 LB JAR) |

Optional Log Sets

Optional Log Sets can be purchased as an upgrade for the Isokern Maximus Linear Fireplace.



Western Driftwood - Cast Concrete

| | |
|---|--------------------|
| Western Driftwood - 36" Set *For the 82L48 Fireplace | ISF-L-36LGC |
| Western Driftwood - 60" Set *For the 82L72 Fireplace | ISF-L-60LGC |
| Western Driftwood - 72" Set *For the 82L96 Fireplace | ISF-L-72LGC |
| Western Driftwood - 96" Set *For the 82L120 Fireplace | ISF-L-96LGC |

Registration Card

Please tear out along line
and send to:

Earthcore Industries
Attn: Technical Department
6899 Phillips Industrial Blvd
Jacksonville, FL 32256

Dealer: _____

Date of Purchase: _____

Date of Installation: _____

Address: _____

City, State, Zip: _____

Phone No.: _____

Burner Model (Circle One): ISF24LB ISF36LB ISF48LB ISF60LB ISF72LB ISF96LB

Fuel Type (Circle One): Natural Gas (NG) Propane (LP)

Serial Number: _____

Buyer: _____

Address: _____

City, State, Zip: _____

Phone No.: _____

Installed By: _____

Address: _____

City, State, Zip: _____

Phone No.: _____

WARRANTY

Customer Service

ISOFLAMES by Earthcore is committed to delivering high-quality service that exceeds customer expectations. You can reach us toll free at 800-642-2920 Monday through Friday from 8:30 AM to 4:30 PM EST for technical support.

Warranty

THE WARRANTY MENTIONED HERE IS ONLY FOR ISOFLAMES LINEAR BURNER

ISOFLAMES products have a ONE YEAR WARRANTY.

It is important to register the ISOFLAMES LINEAR BURNER system with Earthcore.

Please complete the warranty registration card included in this manual on the previous page or visit us online at: <https://earthcore.com/register-your-isokern/>

1. When installed by a professional installer, the ISOFLAMES LINEAR BURNER is covered by a one-year warranty against any performance defects. The stainless-steel burner may brown over time, but it is not considered defective.
2. ISOFLAMES LINEAR BURNER comes with a one-year warranty against breakage, except in cases of mishandling or negligence.
3. ISOFLAMES LINEAR BURNER gas control valves are also backed by a 1-year warranty.
4. This warranty does not cover any parts or surfaces of the ISOFLAMES LINEAR BURNER that are damaged by rain, flooding, pets, wild animals, or birds, negligence, or a disaster.
5. This warranty does not cover any costs related to the installation of the ISOFLAMES LINEAR BURNER or for any parts that may have been damaged during installation.
6. This warranty is valid only for the original purchaser of the product.

earthcore®