



THE OUTDOOR
GREATROOM
COMPANY

Gallery and Modern Mantels Sample Kit

Installation Instructions For:

LG-MNTL-K

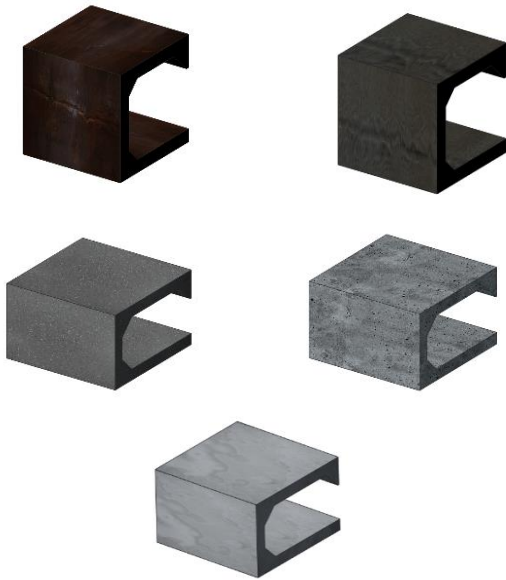

Required Tools



- Power Drill with Phillips bit
For fastening the mantel to wall surface



- Leather Gloves
To protect hands from rough edges on concrete



- Utility Knife
To cut and remove packaging



- Level
To ensure mantel is parallel to floor



- Tape Measure
For locating and centering mantel



- Stud Locator
For locating studs inside a finished wall



- Pencil

IMPORTANT SAFETY INSTRUCTIONS

SAVE THESE INSTRUCTIONS

When using the furnishing, basic precautions should always be followed, including the following:

- Read all instructions before mounting or using the mantel
- Use the furnishing only for its intended use as described in these instructions.

! IMPORTANT !

The fasteners supplied with this furnishing are intended for use in standard wood stud walls only. Minimum wall stud size required is 2" x 4", with drywall or finished wall surface ranging from 1/2" to 3/4" thick. For all other mounting surfaces, use appropriate fasteners as specified by local building codes or other jurisdiction. For mounting to other wall types, if you are at all unsure of the correct fastening method, contact your local building official. Improper mounting may lead to property damage, injury, or death.

MANTEL "SUPERCAS" MATERIAL MEETS NON COMBUSTIBILITY STANDARDS IN ACCORDANCE WITH ASTM E136.

Hanging Bracket



#8 x 2-1/2" Wood Screw (QTY 4)



NOTE: WOOD SCREWS SHOULD ONLY BE USED FOR MOUNTING THE MANTEL TO A WOOD STUD WALL OR OTHER SOLID WOOD SURFACE.

Mounting Instructions

- **Check for damage. Do not use damaged components.**
- **It is required to mount the unit at wall stud locations (if applicable) for proper holding strength and weight distribution.**
- **Be sure to follow your fireplace manufacturer's clearances to non-combustibles or local code if applicable when determining a location for your mantel. Combustibles set on a non-combustible mantle must meet clearance requirements for combustibles.**

1. Choose a location for your mantel and locate studs behind the wall surface using a stud locator. Mark stud locations with a pencil for reference in the next step.
2. Hold the Hanging Bracket up to the wall surface, centered at the desired location, and ensure it is parallel to the floor using a level.

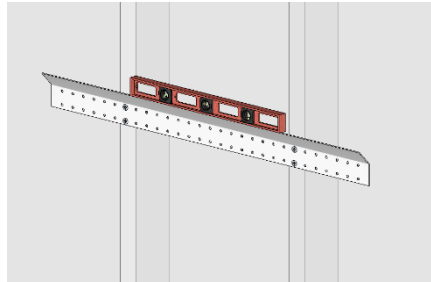

3. Use a pencil to mark hole locations on the bracket, lining it up with a minimum of 2 studs.
4. Insert the supplied #8 x 2-1/2" Wood Screws at the marked hole locations, two screws per stud location as shown below.

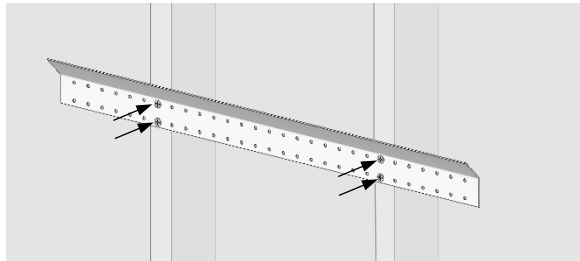

5. Lift the mantel up so that the top edge of the bracket is approximately centered in the cavity at the back side and hold flush to the wall surface. Carefully lower on to the hanging bracket and ensure the mantel is seated properly before placing the full weight of the mantel on the bracket.

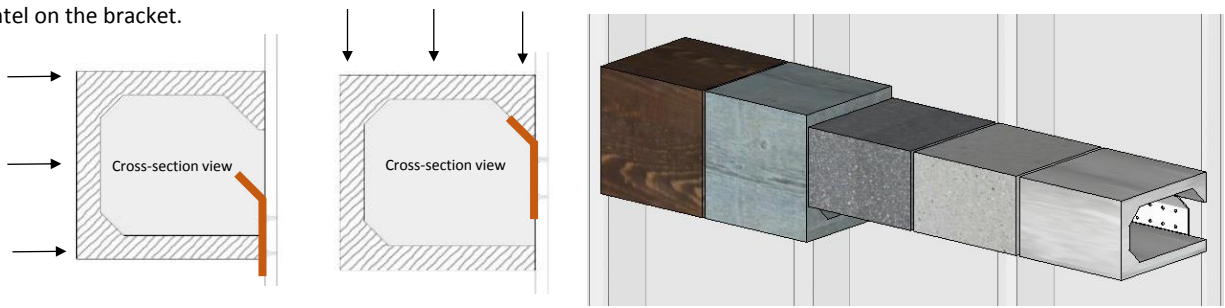

Complete Sample View



14400 Southcross Drive West • Suite 100 • Burnsville, MN 55306
Toll Free: 1-866-303-4028 • Sales@OutdoorRooms.com

Thank you for purchasing an Outdoor GreatRoom Company product! This product was made with pride in the USA.

